

form-scaff



columns



Product Catalogue 2014



Form-Scaff is South Africa's leading supplier of formwork, falsework and scaffolding to the construction and civil engineering industries. Form-Scaff not only manufactures, hires and sells world-class products, but also provides the design skills, technical advice and support that comes with having 50 years experience and more than 30 branches locally and internationally.

This indigenous expertise is complemented by the international depth and breadth of its holding company, Waco International, a leading global commercial and industrial service business focusing on the manufacturing, rental and sale of formwork, falsework and scaffolding equipment as well as the burgeoning re-locatable and modular buildings industry. Waco International operates in Africa, the UK, Australia, New Zealand and Chile.

Form-Scaff is a division of Waco Africa (Pty) Ltd, a joint venture company owned by Waco International and respected local black empowerment company, Kagiso.

Formwork, Shoring & Scaffolding

WACO WORLDWIDE

Modular & Relocatable Buildings

 Australia
New Zealand

 New Zealand

 Ghana
Madagascar
Mozambique
Namibia
South Africa

 United Kingdom

 South Africa

 South Africa



 New Zealand

 South Africa

 Chile
Ghana
Mauritius
Mozambique
Namibia
South Africa
Swaziland
Zambia

 Australia

Disclaimer:
Copyright in this catalogue vests in Form-Scaff, a division of Waco Africa (Proprietary) Limited ("Form-Scaff") and extends inter alia, to the making of copies in whole or in part without the prior written consent of Form-Scaff.

While every effort has been made to ensure the accuracy of the information in this catalogue, we cannot accept responsibility for any errors which may occur as a result of reliance on the contents of this catalogue and are not liable for any loss of any nature that may be incurred as a result of such reliance. Details of any of the products may change without prior notice.

The customer must ensure that 'good practice' is adopted on site by competent persons and that the products shown in this catalogue are erected, used and stripped in accordance with the relevant Codes of Practice and the OHS Act and Regulations 85 of 1993. This catalogue does not contain any design detail but lists and depicts the items available under this product range. The responsibility for design is the responsibility of the customer.

Note: The colours used in this document are for illustrative purposes only and may differ on actual products

Contents



- Page 2** Column Boxes Overview
- Page 3** Column Boxes General Assembly
- Page 4** Circular and Rectangular Column Boxes
- Page 5** Column Box Sundry Items
- Page 6** Column Box Propping System
- Page 7** Column Box Ties
- Page 8** Column Box Application
- Page 9** Adjustable Column Box
- Page 10** Adjustable Column Box Application
- Page 11** Adjustable Column Box Sizes
- Page 12** Column Box Clamp Application

Contact Details

- Page 13** Head Office & Branches

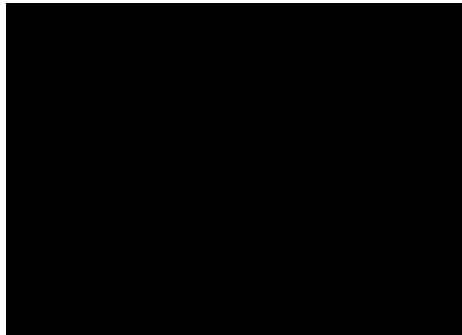
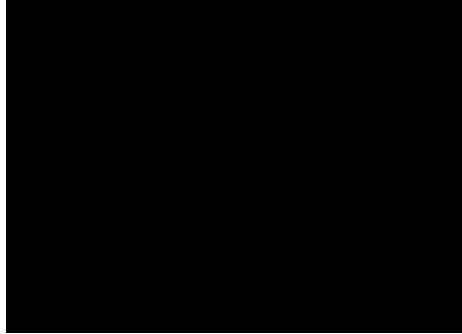



columns



Columns

Form-Scaff has been manufacturing and supplying various column box systems to contractors for the last 50 years. The systems have proven to be versatile and produce high class concrete surface finishes. Form-Scaff is able to produce any shape column boxes to suit the aesthetic and structural requirements of engineers & architects.

System Features

- Quick and easy to assemble and strike.
- Easy to plumb.
- Components are lightweight and easy to manhandle.
- A large variety of shapes & sizes are available.
- Walers and soldiers are not required due to the robust built in stiffeners.
- The column boxes may be extended horizontally and or vertically to suit the customers requirements.
- Ties are only required when two or more column box panels are used side by side.
- The column boxes conform to all South African standards and regulations

General Assembly

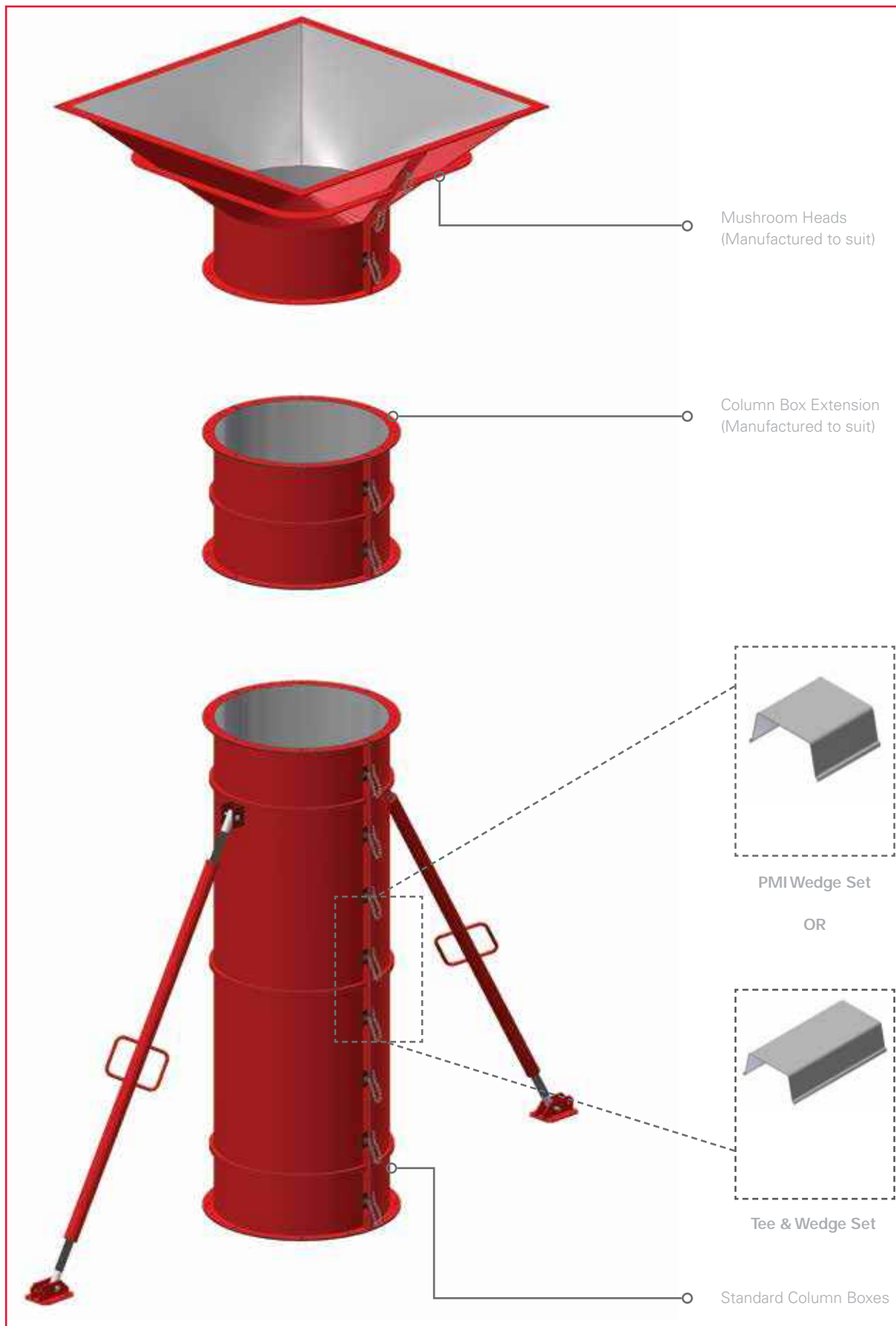

Column Boxes

Circular Column Boxes

Circular Column Boxes are used to form circular concrete columns and the bull-nose ends of concrete columns and walls.

| CODE | DESCRIPTION | MASS(kg) |
|---------|--------------------------------|----------|
| 5705033 | COLUMN BOX CIRCULAR 3000 x 600 | 202.5 |
| 5705034 | COLUMN BOX CIRCULAR 3000 x 550 | 189.0 |
| 5705035 | COLUMN BOX CIRCULAR 3000 x 500 | 175.4 |
| 5705036 | COLUMN BOX CIRCULAR 3000 x 450 | 147.6 |
| 5705037 | COLUMN BOX CIRCULAR 3000 x 400 | 134.6 |
| 5705038 | COLUMN BOX CIRCULAR 3000 x 350 | 121.5 |
| 5705039 | COLUMN BOX CIRCULAR 3000 x 300 | 108.5 |
| 5705157 | COLUMN BOX CIRCULAR 3000 x 230 | 88.6 |

* Other diameters and lengths are also available. Please contact your nearest branch for more information.



Rectangular Column Boxes

Rectangular Column Boxes are used to form square or rectangular shaped concrete columns.

| CODE | DESCRIPTION | MASS(kg) |
|---------|---|----------|
| 5505027 | COLUMN BOX A TYPE MAIN SIDE 3000 x 600 | 105.0 |
| 5510027 | COLUMN BOX A TYPE SMALL SIDE 3000 x 600 | 85.1 |
| 5505029 | COLUMN BOX A TYPE MAIN SIDE 3000 x 450 | 74.7 |
| 5510029 | COLUMN BOX A TYPE SMALL SIDE 3000 x 450 | 59.0 |
| 5505031 | COLUMN BOX A TYPE MAIN SIDE 3000 x 300 | 60.1 |
| 5510031 | COLUMN BOX A TYPE SMALL SIDE 3000 x 300 | 44.4 |
| 5505032 | COLUMN BOX A TYPE MAIN SIDE 3000 x 225 | 52.8 |
| 5510032 | COLUMN BOX A TYPE SMALL SIDE 3000 x 225 | 37.1 |
| 5605017 | COLUMN BOX C TYPE 3000 x 600 | 101.7 |
| 5605019 | COLUMN BOX C TYPE 3000 x 450 | 83.4 |
| 5605022 | COLUMN BOX C TYPE 3000 x 300 | 60.9 |
| 5605024 | COLUMN BOX C TYPE 3000 x 230 | 53.2 |

* Other widths and lengths are also available. Please contact your nearest branch for more information.
Form-Scaff's Econo-Form Panels can also be used as column boxes when used in conjunction with the Column Clamps shown on pages 5 & 12. For details on Econo-Form, please refer to the Form-Scaff Econo-Form Product Catalogue.

A Type Column Boxes are only manufactured for sale.



Column Box A Type Main Side



Column Box A Type Small Side



Column Box C Type

Plastic Buttons

Plastic Buttons are used to plug any unused tie holes.

| CODE | DESCRIPTION | MASS(kg) |
|---------|--------------------------------------|----------|
| 5127001 | ADJUSTABLE COLUMN BOX PLASTIC BUTTON | 0.02 |
| 2960811 | BUTTON 18MM DIA | 0.01 |



Fillets

Fillets are used to chamfer the sharp corners of concrete columns.

| CODE | DESCRIPTION | MASS(kg) |
|---------|---|----------|
| 5520302 | TRIANGULAR PLASTIC FILLET 25 x 25 (PER M) | 0.2 |
| 5520305 | TRIANGULAR STEEL FILLET 25 x 25 (HOLLOW) | 1.0 |
| 5520307 | TRIANGULAR PLASTIC FILLET 20 x 20 PUNCHED | 0.3 |



PMI Wedge Sets

PMI Wedge Sets are used to join the edges of Column Boxes together.

| CODE | DESCRIPTION | MASS(kg) |
|---------|---------------------------------|----------|
| 5595998 | PMI WEDGE ASSEMBLY (WITH CHAIN) | 0.5 |



Wedge Sets

Wedge Sets are used to join the edges of Column Boxes together.

| CODE | DESCRIPTION | MASS(kg) |
|---------|-----------------------|----------|
| 2715555 | KEY (HD) | 0.1 |
| 2715556 | WEDGE CURVED (HD) | 0.1 |
| 2715552 | WEDGE BENT CLIP | 0.1 |
| 2715553 | WEDGE ONLY (STRAIGHT) | 0.1 |



Column Clamp

Column Clamps are used as substitute walers when Econo-Form and Timber Column Boxes are used.

| CODE | DESCRIPTION | MASS(kg) |
|---------|--|----------|
| 5595996 | COLUMN CLAMP ARM ONLY NO. 3 (WITH WEDGE) | 7.0 |
| 5595995 | COLUMN CLAMP ARM ONLY NO. 2 (WITH WEDGE) | 4.4 |
| 5595994 | COLUMN CLAMP ARM ONLY NO. 1 (WITH WEDGE) | 3.6 |
| 5595997 | COLUMN CLAMP WEDGE | 0.3 |



Propping

Push-Pull Props

Tifa Push-Pull Props and Tifa Prop Ties are used to plumb the column boxes.

The Tifa Swivel Foot is used at the base of the Push-Pull Props and Prop Ties to connect the ends of the Props together.

Tifa Connecting Pins 16 x 90 complete with R-Clips are used to connect a Prop to the Column Box and to the Swivel Foot.

| CODE | DESCRIPTION | MASS(kg) |
|---------|----------------------------|----------|
| 5110100 | TIFA PROPTIE H/D | 8.4 |
| 5110022 | TIFA PROP 5700 (PUSH-PULL) | 63.3 |
| 5110201 | TIFA PROP 4200 (PUSH-PULL) | 23.0 |
| 5110024 | TIFA PROP 3100 (PUSH-PULL) | 16.6 |
| 5110007 | TIFA PROP 2500 (PUSH-PULL) | 14.0 |
| 5110008 | TIFA SWIVEL FOOT 200 x 150 | 3.4 |
| 5110021 | TIFA SWIVEL FOOT 300 x 250 | 7.6 |
| 5110090 | TIFA CONNECTING PIN | 0.2 |
| 5110059 | R-CLIP | 0.01 |

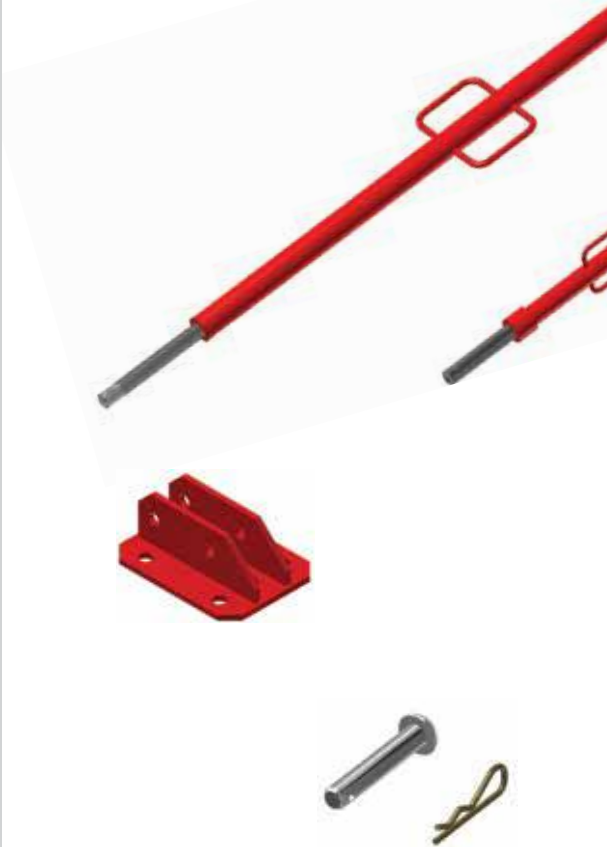

Application - Prop Assembly

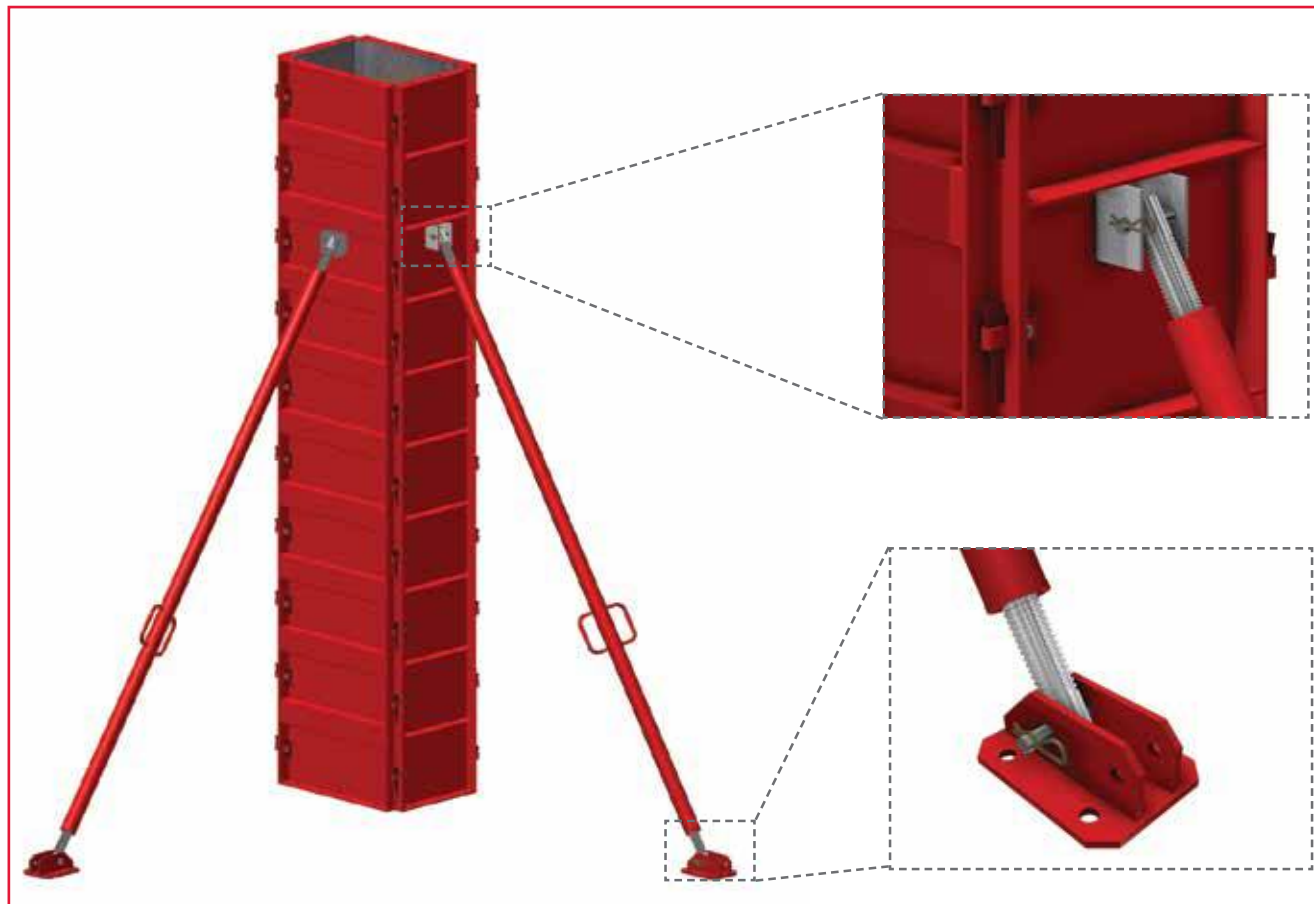

Dywidag Tie Bar

Dywidag Ties are recoverable ties used through tie sleeves.

| CODE | DESCRIPTION | MASS(kg) |
|---------|-----------------------|----------|
| 5405077 | DYWIDAG BAR 15mm 500 | 0.7 |
| 5405078 | DYWIDAG BAR 15mm 1000 | 1.5 |
| 5405079 | DYWIDAG BAR 15mm 1500 | 2.2 |
| 5405085 | DYWIDAG BAR 15mm 2000 | 2.9 |
| 5405086 | DYWIDAG BAR 15mm 2500 | 3.6 |
| 5405087 | DYWIDAG BAR 15mm 3000 | 4.3 |
| 5405088 | DYWIDAG BAR 15mm 3500 | 5.1 |
| 5405089 | DYWIDAG BAR 15mm 4000 | 5.8 |
| 5405092 | DYWIDAG BAR 15mm 4500 | 6.5 |
| 5405093 | DYWIDAG BAR 15mm 5000 | 7.2 |
| 5405094 | DYWIDAG BAR 15mm 5500 | 8.0 |
| 5405095 | DYWIDAG BAR 15mm 6000 | 8.7 |



Dywidag Nuts

The Dywidag Combi Wing Nut, Wing Nut & Washer or Dywidag Nut and Washer combinations can be used with the 15mm Dywidag Bar.

| CODE | DESCRIPTION | MASS(kg) |
|---------|------------------------|----------|
| 5110032 | TIFA WING NUT | 1.8 |
| 5110035 | WASHER 100 x 100 x 6 | 0.5 |
| 5110150 | DYWIDAG COMBI WING NUT | 1.1 |
| 5405076 | DYWIDAG NUT 15 DIA | 0.2 |



Form-Tie Bar

Form-Ties are recoverable ties used through tie sleeves.

| CODE | DESCRIPTION | MASS(kg) |
|---------|--------------------------|----------|
| 5405070 | FORM-TIE BAR F20 (PER M) | 2.5 |
| 5405061 | FORM-TIE BAR F16 (PER M) | 1.6 |
| 5405072 | FORM-TIE BAR F12 (PER M) | 0.8 |



Form-Tie Nut

Form-Tie Nuts are used each end of the Form-Tie.

| CODE | DESCRIPTION | MASS(kg) |
|---------|------------------|----------|
| 5405071 | FORM-TIE NUT F20 | 0.5 |
| 5405062 | FORM-TIE NUT F16 | 0.2 |
| 5405073 | FORM-TIE NUT F12 | 0.1 |



Form-Tie Pad & Washers

The Form-Tie Pad acts as a washer between the Form-Tie Nut and the Panel.

| CODE | DESCRIPTION | MASS(kg) |
|---------|------------------------------|----------|
| 5855602 | 80 x 80 x 6 WASHER | 0.3 |
| 5405064 | FORM-TIE PAD F8 (FOR F16TIE) | 1.2 |

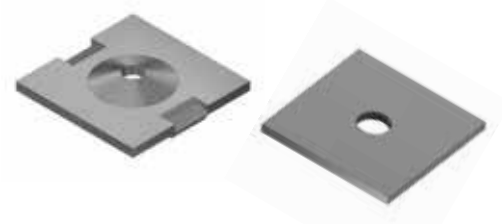

Application - Column Types



Circular Column Box



Rectangular Column Box

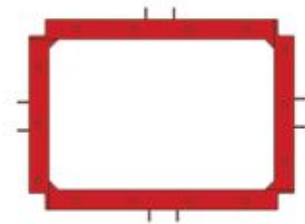

Bull-Nose Column Box

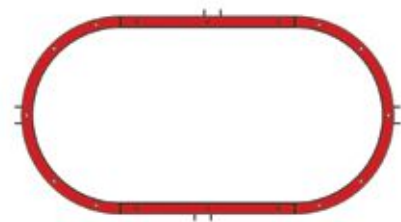

Adjustable Column Panels

Adjustable Column Panels are used to form the vertical sides of concrete columns and provide a range of column sizes from 150mm to 600mm

| CODE | DESCRIPTION | MASS(kg) |
|---------|----------------------------------|----------|
| 5127000 | ADJUSTABLE COLUMN BOX PANEL 2700 | 1073 |
| 5127010 | ADJUSTABLE COLUMN BOX PANEL 1200 | 56.0 |



Working Platform

The Working Platform with foldable legs is attached onto the top of the Adjustable Column Panels.

| CODE | DESCRIPTION | MASS(kg) |
|---------|--------------------------------|----------|
| 5127003 | ADJUSTABLE COLUMN BOX PLATFORM | 30.3 |



Guardrail

The captive Guardrail may be is secured on three sides of the Working Platform.

| CODE | DESCRIPTION | MASS(kg) |
|---------|---------------------------------|----------|
| 5125064 | ADJUSTABLE COLUMN BOX GUARDRAIL | 6.4 |



Bolt Sets

The Bolt Sets are used to connect two Adjustable Column Panels together to form wider or taller Column Boxes.

| CODE | DESCRIPTION | MASS(kg) |
|---------|---------------------------------|----------|
| 2966049 | M20 x 40 BOLT, WASHER & NUT SET | 0.1 |



Adjustable Column Panel Fillet

Fillets are used to chamfer the sharp corners of concrete columns. The Adjustable Column Box (ACB) fillet simply clips onto the Column Panel

| CODE | DESCRIPTION | MASS(kg) |
|---------|--|----------|
| 5127004 | A.C.B. PLASTIC CORNER FILLET (25 x 25) | 0.3 |
| 5127001 | ADJUSTABLE COLUMN BOX PLASTIC PLUG | 0.02 |



Application - Adjustable Column Box



Application - Sizes

The Standard Size Columns that can be formed with a Single Panel Box are:
 150mm, 230mm, 300mm, 350mm, 400mm, 450mm, 500mm, 550mm, 600mm.
 Bigger (wider and/or higher) columns can be formed when bolting panels together.

Examples:



150mm x 150mm



450mm x 230mm



600mm x 600mm

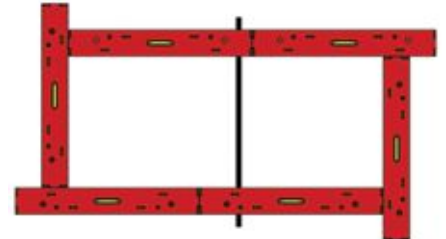

1100mm x 500mm

Typical Examples:

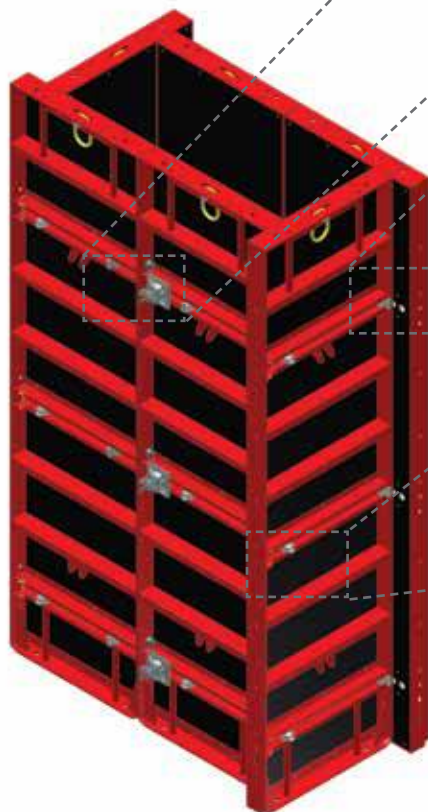

Dywag Tie



Captive T-Bolt



Captive Nut

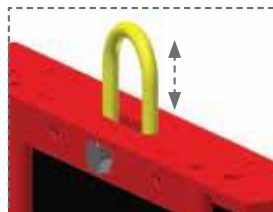

Retractable Lifting Point



Application - Column Clamps

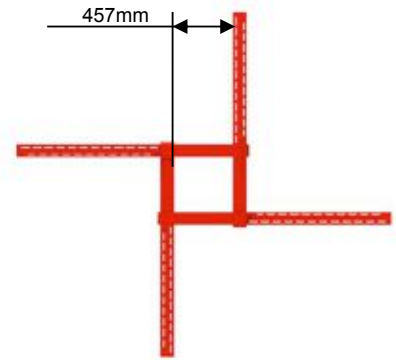
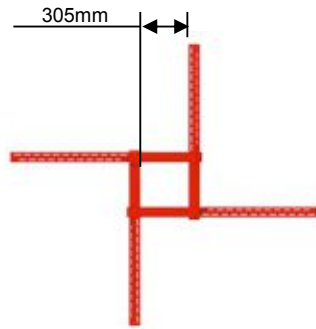
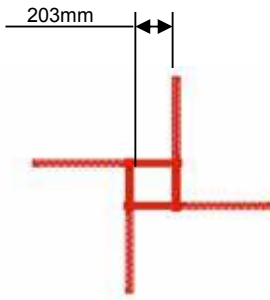

Min Size

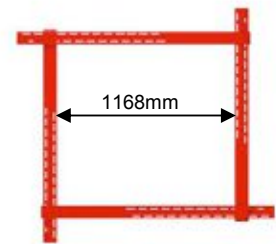
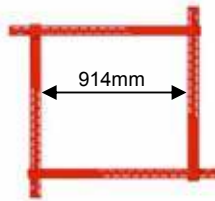
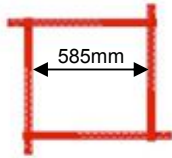

Max Size



**Column Clamps On Econo-Form
Panel Column Box**

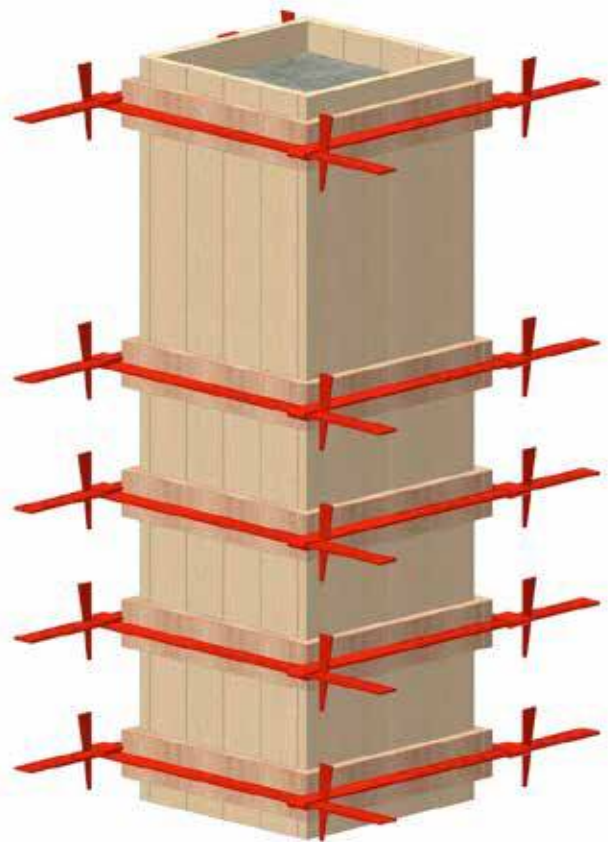

Column Clamps On Timber Column Box

HEAD OFFICE

P.O. Box 669, Isando, 1600
181 Barbara Road, Elandsfontein
Tel 011 842-4000
Fax 011 842-4280

INLAND BRANCHES

BLOEMFONTEIN

P.O. Box 6610, Bloemfontein, 9300
26 Tibbie Visser Street, Estoire S/H District
Tel 051 432-5555
Fax 051 432-4477

BURGERSFORT

P.O. Box 2918, Burgersfort, 1150
Plot 2484, Ext 23 Dirk Winterbach
Street, Burgersfort
Tel 013 004-0200

JOHANNESBURG EAST

P.O. Box 26994, Boksburg, 1462
Tunney Road, Gate 3, Elandsfontein
Tel 011 842-4215
Fax 011 842-4111

JOHANNESBURG - KYA SAND

P.O. Box 2884, Honeydew, 2040
40 Homestead Avenue, Kya Sand
Tel 011 708-2227
Fax 011 708-1159

KATHU

P.O. Box 1235, Kathu, 8446
33 Kalk Street, Industrial Area, Kathu
Tel 053 723-2194, Fax 053 723-1078

KUSILE

P.O. Box 4466, Pretoria, 0001
Kusile Power Station, Balmoral Road,
Mpumalanga
Tel 082 578-4638

LEPHALALE

P.O. Box 7495, Onverwaght, 0557
Rietspruit Plot 23, Portion 46
Witkop Road, Lephalale
Tel 014 763-7982, Fax 014 763-7982

NELSPRUIT

P.O. Box 4485, Nelspruit, 1200
Erf 379, Rocky Drift
Tel 013 758-1036, Fax 013 758-1063

POLOKWANE

P.O. Box 3979, Polokwane, 0700
62 Goud Street, Laboria, Polokwane
Tel 015 293-0450, Fax 015 293-0460

PRETORIA

P.O. Box 4466, Pretoria, 0001
Park Lane North, Highway
Business Park, Rooihuiskraal
Tel 012 621-9900, Fax 012 621-9931

RUSTENBURG

P.O. Box 6996, Rustenburg, 0300
3 Ferro Street, Rustenburg
Tel 014 538-2540, Fax 014 538-0087

SECUNDA

P.O. Box 3781, Secunda, 2302
1 Winkelhaak Road, McGill Ext, Evander
Tel 017 632-4230, Fax 017 632-4234

VEREENIGING

P.O. Box 1010, Vereeniging, 1930
Cnr Telford & Van Riebeeck Street,
Duncanville
Tel 016 455-1611, Fax 016 455-1566

WITBANK

P.O. Box 3869, Witbank, 1035
TP66 Geodesic Cres. Mareden Ext. 3,
Techno Park, Witbank
Tel 013 690 1533, Fax 013 656-3713

COASTAL BRANCHES

BALLITO

P.O. Box 715, Umhlali, 4390
Labora Terra Industrial Park,
Shakas Rock Road, Ballito
Tel 032 947-9430 Fax 032 947-0583

CAPE TOWN

P.O. Box 37068, Chempet, 7442
6 Drill Avenue, Montague Gardens
Tel 021 528-6500
Fax 021 551-1743

DURBAN SOUTH

P.O. Box 485, Umbogintwini, 4120
16 Stroude Place, Isipingo
Tel 031 902-2677
Fax 031 902-2771

EAST LONDON

P.O. Box 2734, Beacon Bay, 5205
5 Ray Craib Crescent, Beacon Bay
Tel 043 748-2558
Fax 043 748-3691

GEORGE

P.O. Box 218, Hartenbos, 6520
Cnr Albert Street & Bridge Road, George
Tel 044 695-0294, Fax 044 695-1040

KZN REGIONAL OFFICE

P.O. Box 33, New Germany, 3620
178-180 Old Main Road, Pinetown
Tel 031 713-9700 Fax 031 713-9715

MARGATE

P.O. Box 1171, Margate, 4275
Industrial Road, Margate
Tel 039 317-1708, Fax 039 317-4073

NEWCASTLE

P.O. Box 906, Newcastle, 2940
22 Schonland Street, Industrial Sites
Tel 034 375-7697, Fax 034 375-6935

PIETERMARITZBURG

P.O. Box 21946, Mayors Walk, 3208
Market Road Ext, Mkondeni
Tel 033 346-1767, Fax 033 346-1753

PORT ELIZABETH

P.O. Box 2112, North End, 6056
4 Kendle Street, Neave Industrial Area
Tel 041 453-2317, Fax 041 453-2524

RICHARDS BAY

P.O. Box 1333, Richards Bay, 3900
111 Alumina Alley, Alton Industrial North
Tel 035 751-1140, Fax 035 751-1094

STRAND

P.O. Box 1654, Somerset West, 7129
Chilwan Crescent
Helderberg, Industrial Park
Tel 021 845-4090, Fax 021 845-4091

INTERNATIONAL BRANCHES

INTERNATIONAL SALES

P.O. Box 669, Isando, 1600
181 Barbara Road, Elandsfontein
Tel 011 842-4000,
Fax 011 388 4550

CHILE - COPIAPO

Rio Copiapo, 1949
Plaza Comercio 2, Modulo 8 –
Panamericana Norte, Copiapo, Chile
Tel +565 254 1561

CHILE - SANTIAGO

Cerro Portezuelo, 9801
Parque Industrial Portezuelo,
Quilicura, Santiago de Chile
Tel +562 738-5019, Fax +562 738-6521

GHANA - ACCRA

Plot L16, Accra Tema Motorway,
Off Spintex Road,
Motorway Industrial Area,
Accra, Ghana
Cell +27 82 829 6627

MAURITIUS - PORT LOUIS

P.O. Box 748, Bell Village,
Port Louis Western
Plaine Lauzun Industrial Estate
Tel +230 211-039, Fax +230 211-0392

MOZAMBIQUE – PEMBA

Rua Estrada Nacional 106
Muxara, Pemba
Tel: +258 84 714 3142

NAMIBIA - SWAKOPMUND

P.O. Box 2484, Swakopmund,
36 Hidipo Hamutenya Street, Swakopmund
Tel +26464 46-2020, Fax +26464 46- 2050

NAMIBIA - WINDHOEK

P.O. Box 20286, Windhoek, 9000
5 Nickel Street, Prosperitas
Tel +26461 23-3693, Fax +26461 23-3272

SWAZILAND - MATSAPHA

P.O. Box C1769, The Hub, Manzini M200,
Swaziland Lot 814 King Mswati III Avenue,
Swaziland, Matsapha
Tel +268 2518 8360, Fax +27 12 349 9871

ZAMBIA - KITWE

Karibu Business Park. Kitwe / Ndola
Dual Carriageway, Kitwe
Tel +26096 6880009 / +26095 5593676
Cel +260966 923 854



Technical Advice Centre 0800 20 50 29 / 011 842-4011

WACO AFRICA / HEAD OFFICE: PO Box 669, Isando, 1600. 181 Barbara Road, Elandsfontein. Tel 011 842-4000, Fax 011 842-4280

www.formscaff.com