

**Product Catalogue**  
**Vertical Formwork**

**FS multi-form**



**FS form-scaff**

**Formwork & Scaffolding**  
Solutions

We are  
**WACO**



Form-Scaff is South Africa's leading supplier of formwork, falsework and scaffolding to the construction and civil engineering industries. Form-Scaff not only manufactures, hires and sells world-class products, but also provides the design skills, technical advice and support that comes with having 50 years experience and more than 30 branches locally and internationally.

### **We are Waco International**

Form-Scaff is part of Waco International, a focused equipment rental and industrial services business with operations in Africa (South Africa and other sub-Saharan African countries), Australasia (Australia and New Zealand) and the United Kingdom.

The Group provides services in the areas of formwork, shoring and scaffolding, insulation, painting and blasting, hydraulics and suspended access platforms, relocatable modular buildings, portable sanitation products and integrated hygiene services.

#### **Disclaimer:**

Copyright in this catalogue vests in Form-Scaff, a division of Waco Africa (Proprietary) Limited ("Form-Scaff") and extends inter alia, to the making of copies in whole or in part without the prior written consent of Form-Scaff.

While every effort has been made to ensure the accuracy of the information in this catalogue, we cannot accept responsibility for any errors which may occur as a result of reliance on the contents of this catalogue and are not liable for any loss of any nature that may be incurred as a result of such reliance. Details of any of the products may change without prior notice.

The customer must ensure that 'good practice' is adopted on site by competent persons and that the products shown in this catalogue are erected, used and stripped in accordance with the relevant Codes of Practice and the OHS Act and Regulations 85 of 1993. This catalogue does not contain any design detail but lists and depicts the items available under this product range. The responsibility for design is the responsibility of the customer.

**Note:** The colours used in this document are for illustrative purposes only and may differ on actual products

# Contents



**multi-form**

- Page 2** Multi-Form Overview
- Page 3** General Assembly
- Page 4** Soldiers & Walers
- Page 5** Splices & Channels
- Page 6** Plywood & Ties
- Page 8** Propping System
- Page 9** Access Brackets
- Page 10** Climbing
- Page 12** Lifting

## Contact Details

- Page 13** Head Office & Branches

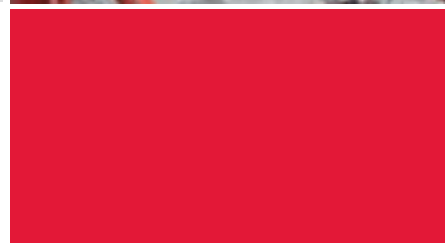
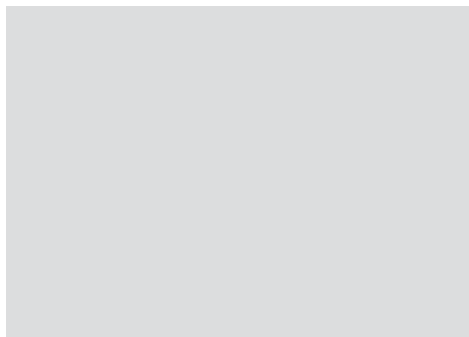
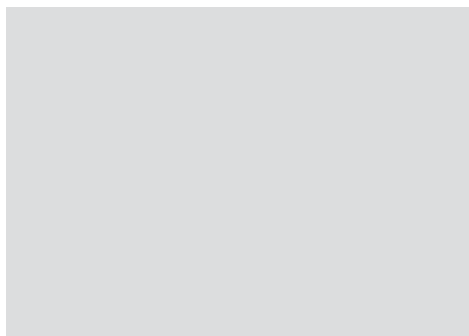





# multi-form



## Multi-Form Walls

Form-Scaff's unique Multi-Form Beam also doubles up as a soldier in the Multi-Form wall system. With twin channel Walers behind for strength and high quality plywood facing on the front, Multi-Form guarantees a smooth off-shutter finish.

The standard size panels are made up at our premises and delivered to site. Off-shutter columns, walls and lift-shafts are possible with this lightweight walling system.

### System Features

- Unique Multi-Form Beam as the soldier.
- The Walers and Splices self-align the panels.
- Splices and Wedges ensure water-tight connections between panels.
- Straight and circular applications are available.
- Climbing and lifting applications are available.
- Offers a smooth off-shutter finish.



## General Assembly

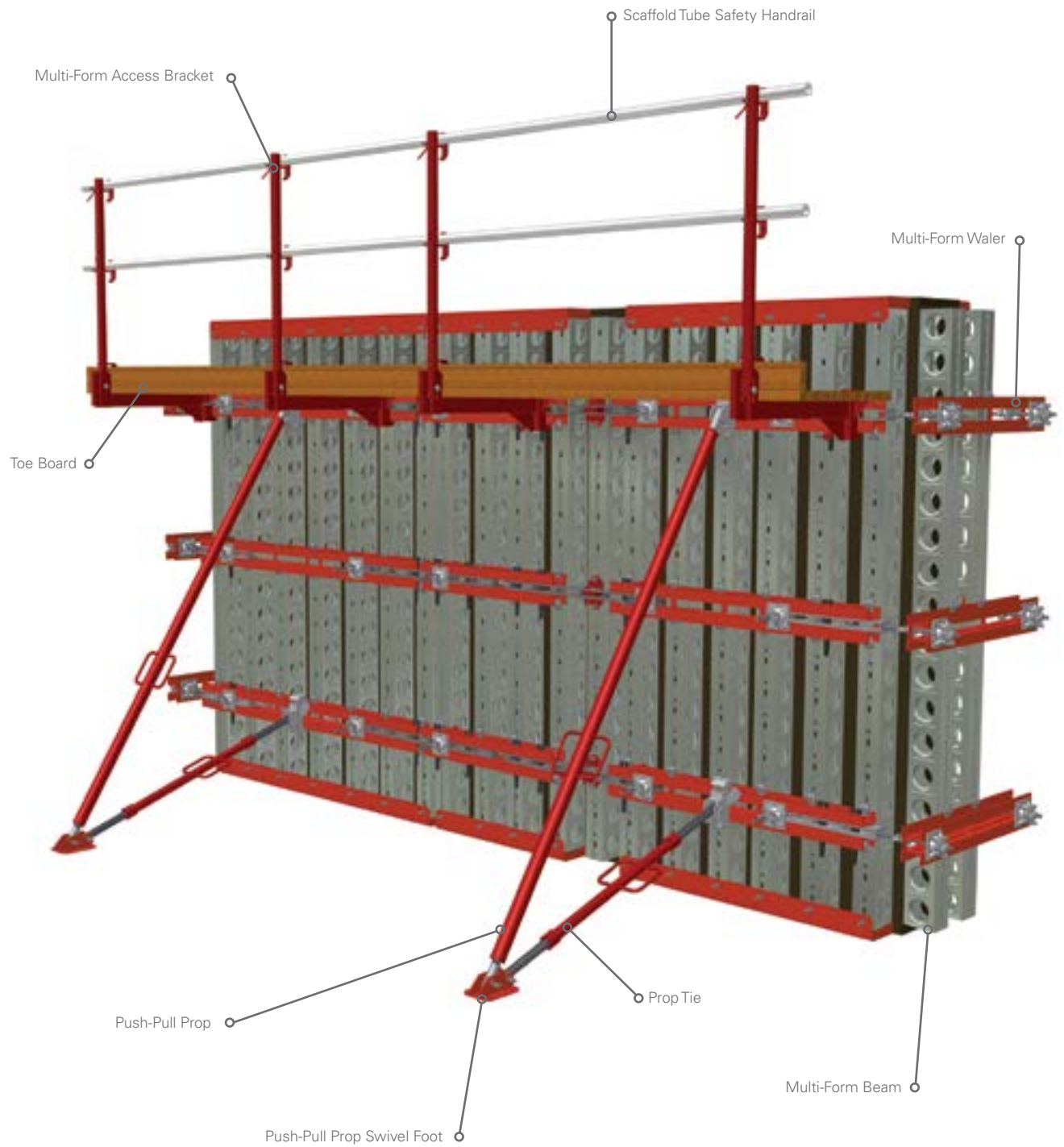

## Multi-Form Beams

Multi-Form Beams are used as the soldiers, which support the plywood facing.

CODE	DESCRIPTION	MASS(kg)
1120008	MULTI-FORM BEAM 3900	28.4
1120014	MULTI-FORM BEAM 3600	26.4
1120013	MULTI-FORM BEAM 3300	24.4
1120006	MULTI-FORM BEAM 3000	22.4
1120015	MULTI-FORM BEAM 2700	20.3
1120005	MULTI-FORM BEAM 2400	18.1
1120004	MULTI-FORM BEAM 2100	15.8
1120003	MULTI-FORM BEAM 1800	13.6
1120002	MULTI-FORM BEAM 1500	11.3
1120016	MULTI-FORM BEAM 1200	9.2
1120001	MULTI-FORM BEAM 900	7.3



## Multi-Form Walers

Multi-Form Walers are used to straighten and stiffen the Multi-Form Beams in an assembled Multi-Form Panel.

CODE	DESCRIPTION	MASS(kg)
1605074	MULTI-FORM WALER 2400	48.7
1605073	MULTI-FORM WALER 1800	36.5
1605010	MULTI-FORM WALER 1500	30.3
1605072	MULTI-FORM WALER 1200	24.3
1605071	MULTI-FORM WALER 900	18.5
1605025	MULTI-FORM WALER 600	11.9



## Internal Corners

Multi-Form Internal Corners 600 x 600 are walers, attached to the Multi-Form Beam soldiers, to form a 90° internal corner panel.

CODE	DESCRIPTION	MASS(kg)
1605081	MULTI-FORM INTERNAL CORNER 600 X 600	29.5



## Stop-end Waler Splices and Wedges

Multi-Form Waler Splices c/w Waler Wedges are used to join two Multi-Form Panels together side by side. Multi-Form Waler Splices also straighten and align gang-formed Panels. Multi-Form Waler Stop-end Splices c/w Waler Wedges are used to secure stop-ends in position.

CODE	DESCRIPTION	MASS(kg)
1605013	MULTI-FORM WALER STOP-END SPLICE	5.6
1605012	MULTI-FORM WALER SPLICE 1470	15.4
1605003	MULTI-FORM WALER SPLICE 990	10.4
1605004	MULTI-FORM WALER WEDGE	0.8



## Hinged Splices

On splayed walls, Multi-Form Waler Hinged Splices c/w Waler Wedges are used to join two Multi-Form Panels together side by side. Multi-Form Waler Hinged Splices 85-305 are used where the splay angle of a concrete wall is between 85° and 305°. Multi-Form Waler Hinged Splices 40-320 are used where the splay angle of a concrete wall is between 40° and 320°.

CODE	DESCRIPTION	MASS(kg)
1605042	MULTI-FORM WALER HINGED SPLICE 85-305	15.4
1605105	MULTI-FORM WALER HINGED SPLICE 40-320	15.2



## Waler Spacer Brackets

Multi-Form Waler Spacer Brackets are used to seat the Multi-Form Beams up against the various types of Multi-Form Waler Splices.

CODE	DESCRIPTION	MASS(kg)
1605015	MULTI-FORM WALER SPACER BRACKET	1.3
1605083	CONNECTING PIN 19 X 90	0.1
5110059	R-CLIP 70 X 3	0.01

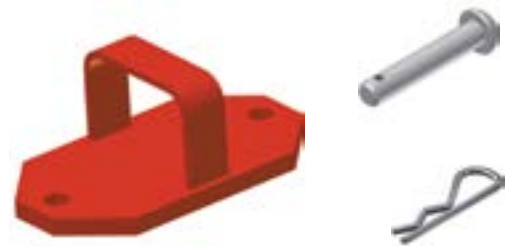

## Waler Channels

Multi-Form Waler Channels are used as a bridge to keep the Cup Square Bolts and Flange Clips in position.

CODE	DESCRIPTION	MASS(kg)
1605007	MULTI-FORM WALER CHANNEL	0.4
1605008	MULTI-FORM WALER CUP SQUARE BOLT	0.1
1605036	MULTI-FORM LINDAPTOR	0.1
1605200	MULTI-FORM KWIK-FIX BOLT	0.1
1605201	MULTI-FORM KWIK-FIX NUT	0.1





# Plywood & Ties

## WISA-Form Plywood, Plastic Plugs & Countersunk Screws

21mm Thick WISA-Form Combi Plywood is used as a facing on the Multi-Form Panels. The Phenolic coating on the plywood provides a very good off-shutter concrete finish. Plastic Plugs are used to seal the tie holes that are not in use. Countersunk Screws are used to fix the plywood to the Multi-Form Beams.

CODE	DESCRIPTION	MASS(kg)
5120017	2400 X 600 X 21mm WISA-FORM PLYWOOD	20.5
5120011	2700 X 1220 X 21mm WISA-FORM PLYWOOD	46.9
5110300	PLASTIC PLUGS (21/15)	0.01
1605039	MULTI-FORM COUNTERSUNK SCREW X 55	0.01
1605027	MULTI-FORM TURBO SCREW 10 X 50	0.01

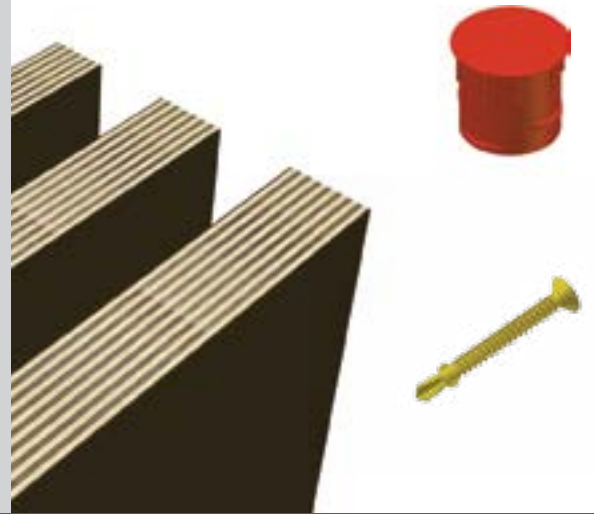

## Waler Tie Bracket 45°

Multi-Form Waler Tie Brackets 45° are used to locate the Dywidag Ties at the 90° external corners of assembled Multi-Form Panels.

CODE	DESCRIPTION	MASS(kg)
1605014	MULTI-FORM WALER TIE BRACKET 45°	3.8



## Tie System

Dywidag Bars 15 Diameter with Dywidag Combi Wing Nuts should be used with the Multi-Form System.

CODE	DESCRIPTION	MASS(kg)
5405095	DYWIDAG BAR 15mm 6000	8.7
5405094	DYWIDAG BAR 15mm 5500	8.0
5405093	DYWIDAG BAR 15mm 5000	7.2
5405092	DYWIDAG BAR 15mm 4500	6.5
5405089	DYWIDAG BAR 15mm 4000	5.8
5405088	DYWIDAG BAR 15mm 3500	5.1
5405087	DYWIDAG BAR 15mm 3000	4.3
5405086	DYWIDAG BAR 15mm 2500	3.6
5405085	DYWIDAG BAR 15mm 2000	2.9
5405079	DYWIDAG BAR 15mm 1500	2.2
5405078	DYWIDAG BAR 15mm 1000	1.5
5405077	DYWIDAG BAR 15mm 500	0.7
5110150	DYWIDAG COMBI WING NUT	1.1





## Application - Infill Sections

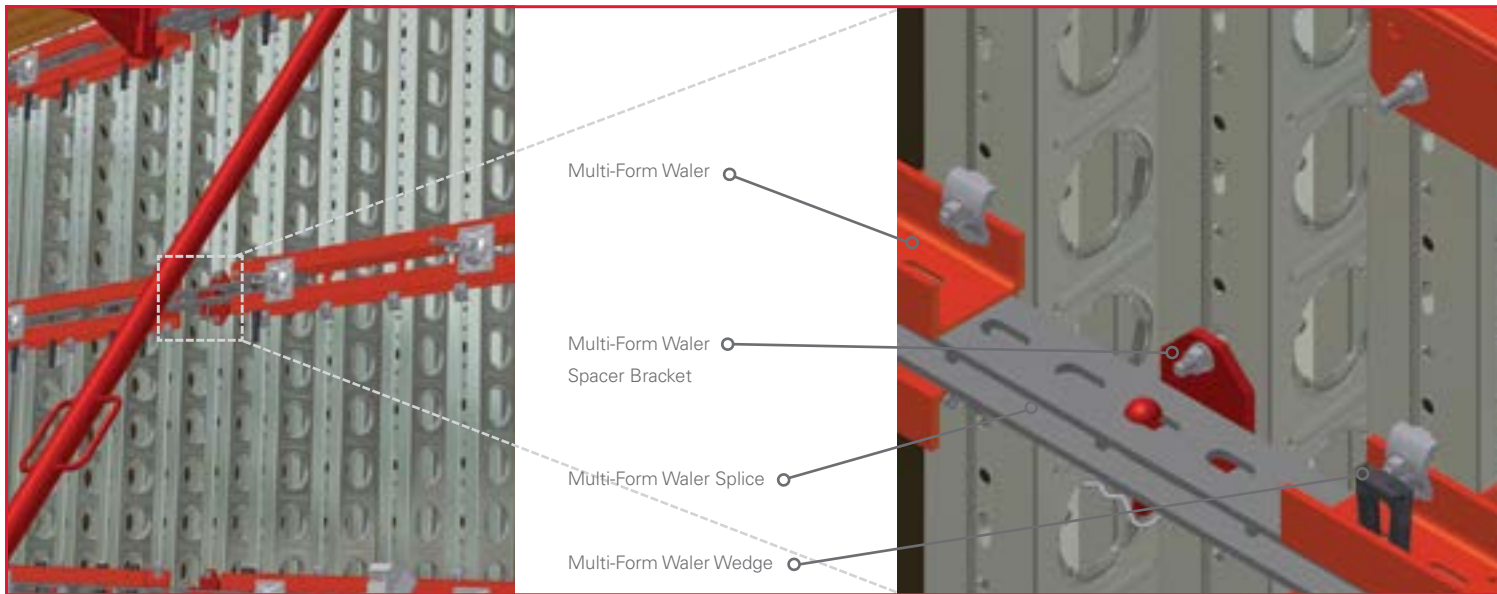

## Application - Corners & Stop-ends

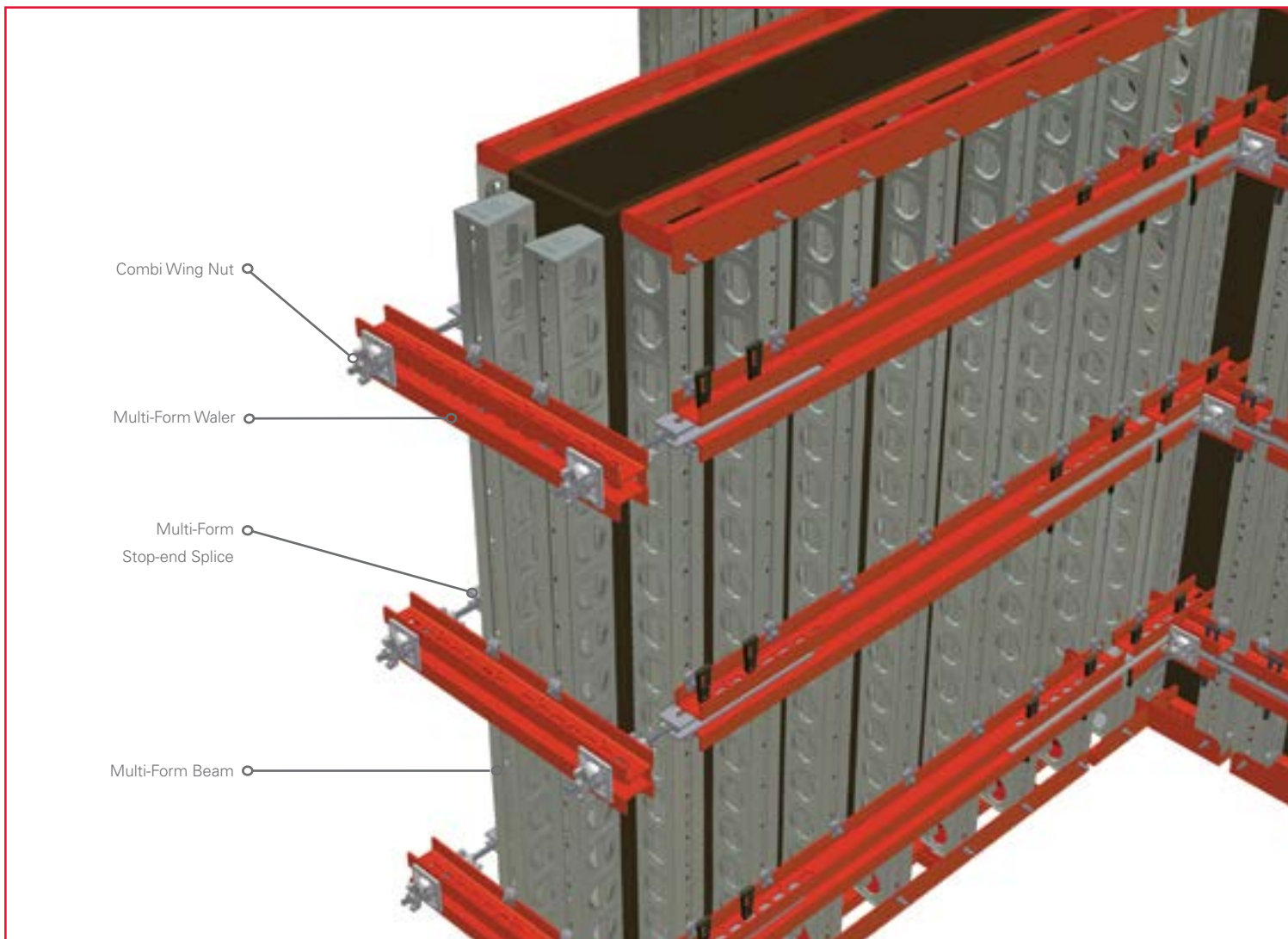

# Propping System

## Push-Pull Props

Push-Pull Props and Push-Pull Prop Ties are used to plumb the Multi-Form Panels.

CODE	DESCRIPTION	MASS(kg)
5110022	PUSH-PULL PROP 5700	63.3
5110201	PUSH-PULL PROP 4200	23.0
5110024	PUSH-PULL PROP 3100	16.6
5110007	PUSH-PULL PROP 2500	14.0
5110100	PUSH-PULL PROPTIE	8.4



## Waler Attachment Brackets

Multi-Form Waler Attachment Brackets are used to fix the Push-Pull Props to the Multi-Form Walers.

CODE	DESCRIPTION	MASS(kg)
1605016	MULTI-FORM WALER ATTACHMENT BRACKET	3.6



## Swivel Foot

The Push-Pull Prop Swivel Foot is used at the base of the Push-Pull Props and Push Pull Prop Ties to connect the ends of the Props together.

CODE	DESCRIPTION	MASS(kg)
5110008	PUSH-PULL PROP SWIVEL FOOT 200 X 150	3.4
5110021	PUSH-PULL PROP SWIVEL FOOT 300 X 250	7.6



## Connecting Pin & R-Clip

Connecting Pins 16 x 90 c/w R-Clips 70 x 3 are used to connect a Prop to the Multi-Form Waler Attachment Bracket and to the Swivel Foot.

CODE	DESCRIPTION	MASS(kg)
5110090	CONNECTING PIN 16 X 90	0.2
5110059	R-CLIP 70 X 3	0.01



### Access Brackets

Multi-Form Access Brackets are used to provide access for site personnel.

CODE	DESCRIPTION	MASS(kg)
1605017	MULTI-FORM ACCESS BRACKET	10.2



### Application - Propping & Access

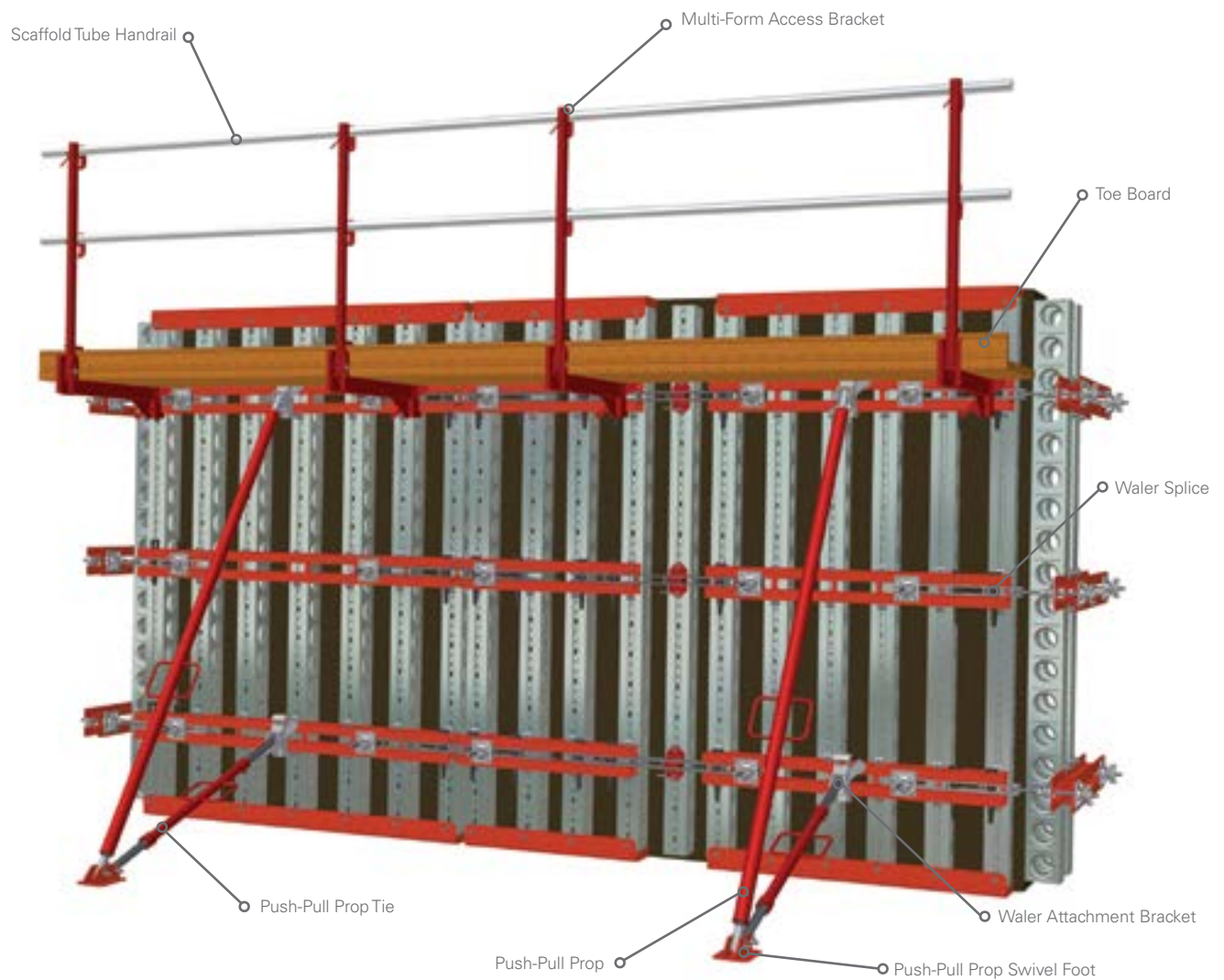



## Anchor Screws and Extractor Tools

The relevant size Anchor Screw c/w Set Screw is used to secure a Form Wall Bracket to the concrete wall. The Extractor Tool is used to remove the Anchor Screw from the concrete.

CODE	DESCRIPTION	MASS(kg)
2965904	ANCHOR SCREW M36 X 430	4.0
2965903	ANCHOR SCREW M24 X 280	1.1
2965902	ANCHOR SCREW M20 X 200	1.0
2965901	ANCHOR SCREW M20 X 120	0.9
2965905	ANCHOR SCREW EXT TOOL M20	2.2
2965906	ANCHOR SCREW EXT TOOL M24	2.2
2965907	ANCHOR SCREW EXT TOOL M36	3.9



## Wall Brackets

Form Wall Brackets are used to secure Form Support Brackets in position. The relevant size Anchor Screw c/w Set Screw is used to secure each Form Wall Bracket to the concrete wall.

CODE	DESCRIPTION	MASS(kg)
5405025	FORM WALL BRACKET	4.5



## Support Brackets

When climbing the Multi-Form System, Form Support Brackets may be used to support the system at various levels of the climb.

CODE	DESCRIPTION	MASS(kg)
5405023	FORM SUPPORT BRACKET	25.7



## Hanging Brackets

Form Hanging Brackets are used to provide access for site personnel and to recover the Anchor Screws from previous concrete pours.

CODE	DESCRIPTION	MASS(kg)
5405024	FORM HANGING BRACKET	23.9





multi-form

## Application - Climbing

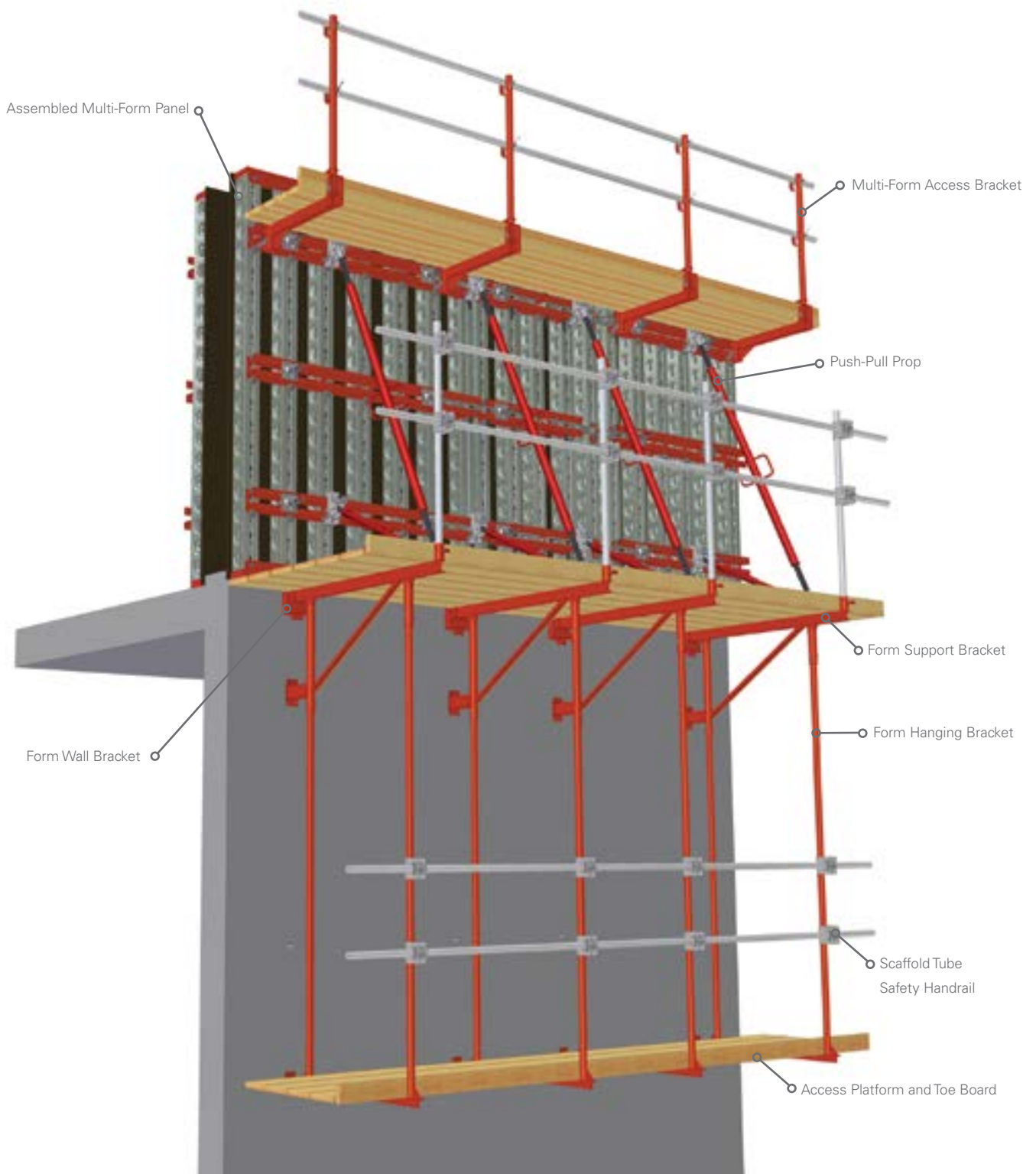

## Lifting Beams

Tifa Lifting Beams must be used in conjunction with the Multi-Form Lifting Clamp to lift the Multi-Form System.

CODE	DESCRIPTION	MASS(kg)
5110093	TIFA LIFTING BEAM 3300	175.0



## Lifting Clamps

Multi-Form Lifting Clamps are used to lift the Multi-Form System.

CODE	DESCRIPTION	MASS(kg)
1605034	MULTI-FORM LIFTING CLAMP	12.5



## Application - Lifting

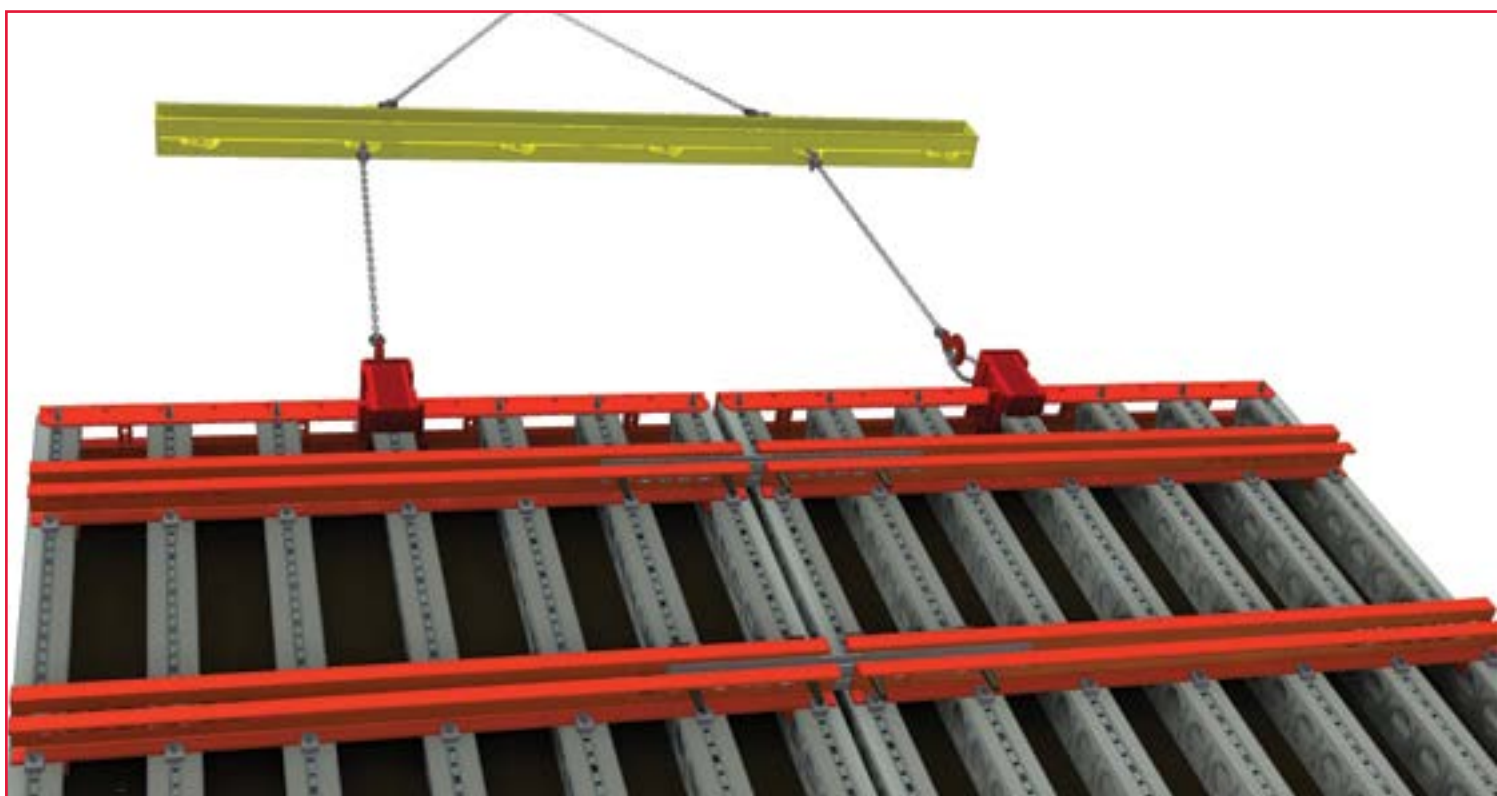



### International Branches

#### Botswana - Gaborone

Plot 31364, Gaborone North,  
Gaborone,  
Botswana  
+267 396 2000

#### Eswatini - Matsapha

36 Ingaja Street,  
Matsapha,  
Eswatini  
+268 2518 8360

#### Ghana - Accra

Plot 29, Off Spintex Road, Tema  
Motorway Industrial Area, Accra,  
Ghana  
+233 303 973 722

#### Mauritius - Port Louis

72201, Petit Camp,  
Phoenix (Near Bagatelle Dam),  
Mauritius  
+230 286 6176 / +230 5940 2551

#### Mozambique - Maputo

Belulane, Parcella 15988, Boane  
Matola Rio, Maputo,  
Mozambique  
+258 84 163 8905

#### Namibia - Windhoek

Cnr Nickle & Michelle, McClean Street,  
Prosperita, Windhoek,  
Namibia  
+264 61 425 350

#### Tanzania – Dar es Salaam

Cnr Mwaikibaki Road & Kilimani Close  
Plot 1034/5 Mbezi Kawe  
Dar es Salaam, Tanzania  
+255 74 299 8022

#### Zambia - Kitwe

12867 Chingola Road, Saloba Business Park,  
Chimwemwe, Kitwe,  
Zambia  
+260 966 880 009

#### Zambia - Lusaka

Plot 397 A/3/B Kafue Road  
Lusaka,  
Zambia  
+260 968 491 061

#### Zambia - Solwezi

Suite 12, Kansanshi Road, Plot No 2945,  
Solwezi,  
Zambia  
+260 768 935 762

### South African Branches

#### Ballito

Labora Terra Industrial Park  
Shakas Rock Road, Umhlali  
Ballito, KwaZulu Natal  
+27 (0) 32 947 9430

#### Bloemfontein

26 Tibbie Visser Street  
Estoire, Bloemfontein  
Free State  
+27 (0) 51 432 5555

#### Cape Town

6 Rondevallei Road, Hagley  
Kuilsrivier, Cape Town  
Western Cape  
+27 (0) 21 528 6500

#### Durban

16 Stroude Place, Prospection  
Isipingo,  
KwaZulu Natal  
+27 (0) 31 902 2677

#### East London

5 Ray Craib Crescent,  
Beacon Bay North  
Beacon Bay, Eastern Cape  
+27 (0) 43 748 2558

#### Emalahleni

Stand 64, Geodesic Crescent  
Marelden Ext 3  
Mpumalange  
+27 (0) 13 690 2833

#### George

10 Ring Road, George Industrial  
George,  
Western Cape  
+27 (0) 44 695 0204

#### Gqeberha

4 Kendle Street  
Neave Industrial Area,  
Eastern Cape  
+27 (0) 41 453 2317

#### Kathu

33 Kalk Street, Industrial Area  
Kathu,  
Northern Cape  
+27 (0) 53 723 2194

#### Margate

Airport Park, Links Road  
Margate Ext 3,  
KwaZulu Natal  
+27 (0) 39 317 1708

#### Mbombela

Erf 379, Rocky Drift  
White River,  
Mbombela  
+27 (0) 13 758 1036

#### Midrand

Poplar Crescent, Lords View  
Industrial Park, Klipfontein  
Chloorkop X66, Gauteng  
+27 (0) 10 601 6313

#### Newcastle

6 Schonland Street  
Riverside Industrial Area  
Newcastle, KwaZulu Natal  
+27 (0) 34 375 7697

#### Polokwane

62 Goud Street, Laboria  
Polokwane Ext 8,  
Limpopo  
+27 (0) 15 293 0450

#### Richards Bay

111 Allumina Allee St,  
Alton, Richards Bay  
KwaZulu Natal  
+27 (0) 35 751 1140

#### Rustenburg

3 Ferro Street, Rustenburg  
North West Province  
+27 (0) 14 538 2540

### Head Office

181 Barbara Road,  
Elandsfontein, Gauteng  
Tel +27 (0) 11 842 4000



Waco Africa / Head Office:  
181 Barbara Road, Elandsfontein, Gauteng  
Tel: +27 (0) 11 842 4000



[www.formscaff.com](http://www.formscaff.com)

