

**Product Catalogue**  
**Horizontal Formwork**

**FS kwik-deck**



**FS form-scaff**

**Formwork & Scaffolding**  
Solutions

We are  
**WACO**



Form-Scaff is South Africa's leading supplier of formwork, falsework and scaffolding to the construction and civil engineering industries. Form-Scaff not only manufactures, hires and sells world-class products, but also provides the design skills, technical advice and support that comes with having 50 years experience and more than 30 branches locally and internationally.

### **We are Waco International**

Form-Scaff is part of Waco International, a focused equipment rental and industrial services business with operations in Africa (South Africa and other sub-Saharan African countries), Australasia (Australia and New Zealand) and the United Kingdom.

The Group provides services in the areas of formwork, shoring and scaffolding, insulation, painting and blasting, hydraulics and suspended access platforms, relocatable modular buildings, portable sanitation products and integrated hygiene services.

#### **Disclaimer:**

Copyright in this catalogue vests in Form-Scaff, a division of Waco Africa (Proprietary) Limited ("Form-Scaff") and extends inter alia, to the making of copies in whole or in part without the prior written consent of Form-Scaff.

While every effort has been made to ensure the accuracy of the information in this catalogue, we cannot accept responsibility for any errors which may occur as a result of reliance on the contents of this catalogue and are not liable for any loss of any nature that may be incurred as a result of such reliance. Details of any of the products may change without prior notice.

The customer must ensure that 'good practice' is adopted on site by competent persons and that the products shown in this catalogue are erected, used and stripped in accordance with the relevant Codes of Practice and the OHS Act and Regulations 85 of 1993. This catalogue does not contain any design detail but lists and depicts the items available under this product range. The responsibility for design is the responsibility of the customer.

**Note:** The colours used in this document are for illustrative purposes only and may differ on actual products

# Contents



**kwik-deck**

- Page 2** Kwik-Deck Overview
- Page 3** General Assembly
- Page 4** Supportwork - Props
- Page 5** Trusses & Tri-Pods
- Page 6** Supportwork - Kwik-Stage
- Page 7** Ledgers & Tubes
- Page 8** Drop-Heads
- Page 9** Beams and Panels
- Page 10** Patching
- Page 12** Cantilevers
- Page 15** Guardrails
- Page 16** Slab-Edges

## Contact Details

- Page 17** Head Office & Branches

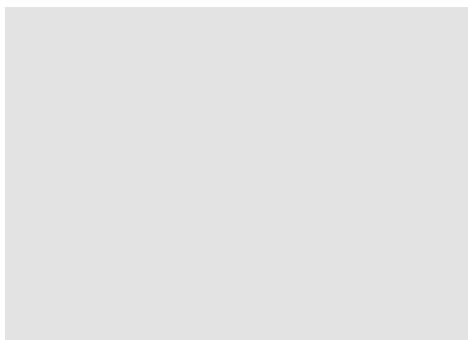
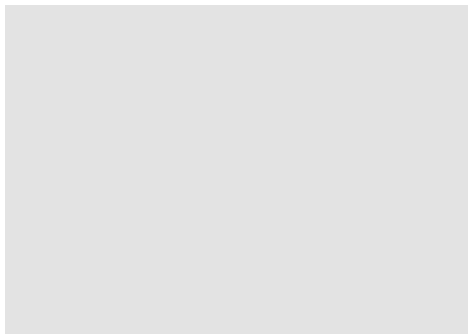



# kwik-deck



## Kwik-Deck Decking

Kwik-Deck is a high quality, fast erect and strip decking system that combines the tried and tested features of the old Tim-Deck system with innovative new thinking and design.

Compatibility on all three supportwork systems, Kwik-Stage, Alu-Up Props and BS Props makes Kwik-Deck the most versatile decking system available in South Africa. Locally manufactured in our ISO 9001/2000 accredited factory, the machined interlocking fit between Panel, Beam and Drop-Head not only ensures a smooth concrete finish, but also makes the system extremely safe from erection through to dismantling.

### System Features

- Rigid interlocking between Panels, Beams and Drop-Heads.
- Compatible with three different supportwork systems.
- Stability of Kwik-Stage around the slab perimeter.
- The unique multiple support point Cantilever Bracket ensures that the grid always remains in the same aesthetically pleasing direction.
- 850mm safe cantilevered working platform.
- One product to do safe handrails around the deck as well as the slabs below.
- A complete and cost effective patching solution.



## General Assembly

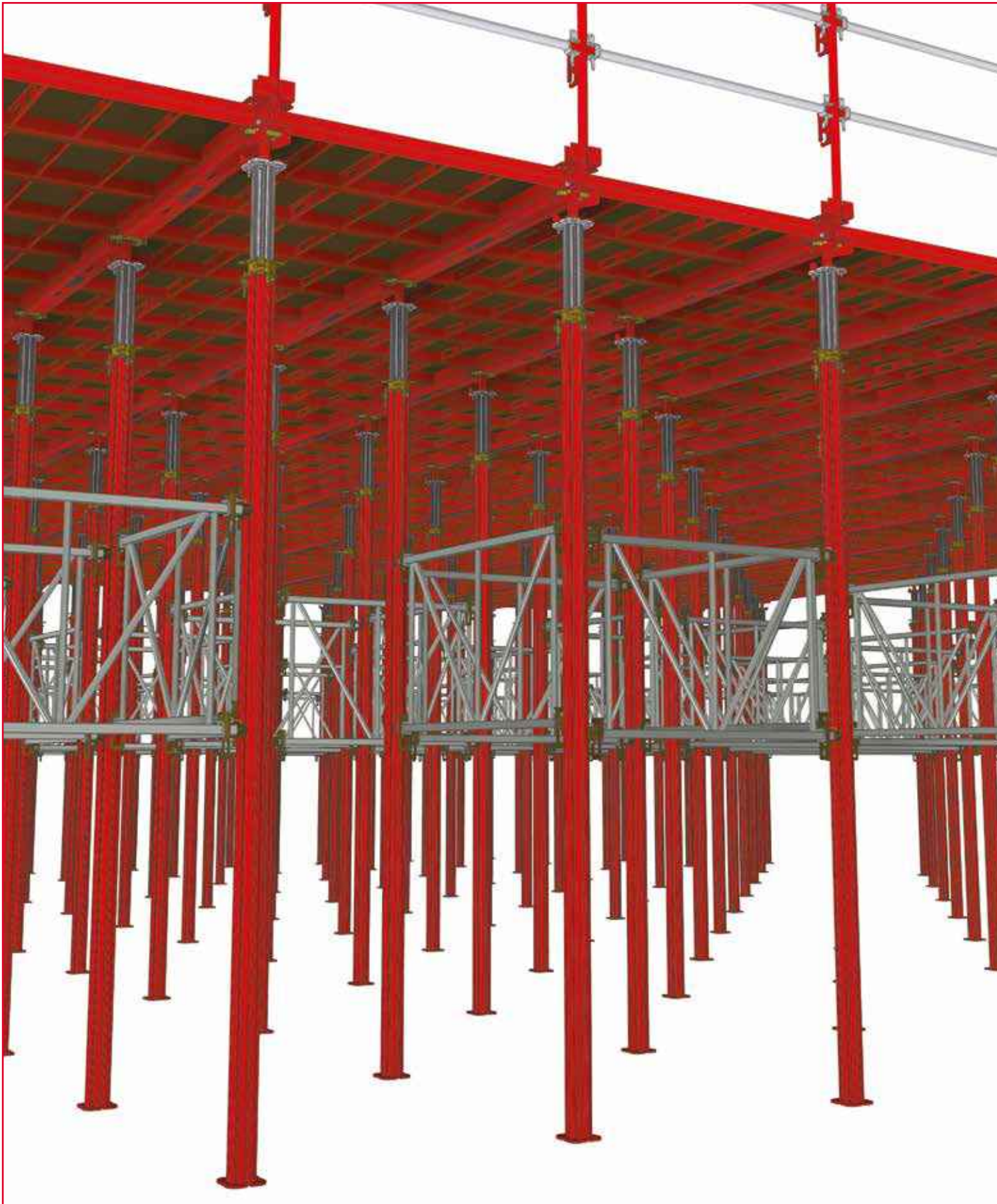

# Supportwork - Props

## BS Props

BS Props are used to support the Kwik-Deck system to a propping height of 4000mm.

CODE	DESCRIPTION	MASS(kg)
5105007	BS-0 PROP INNER	8.6
5105008	BS-0 PROP OUTER	11.1
1520002	BS-1 PROP INNER	11.8
1520003	BS-1 PROP OUTER	16.4
1520006	BS-2 PROP COMPLETE	29.8

## Prop Heights

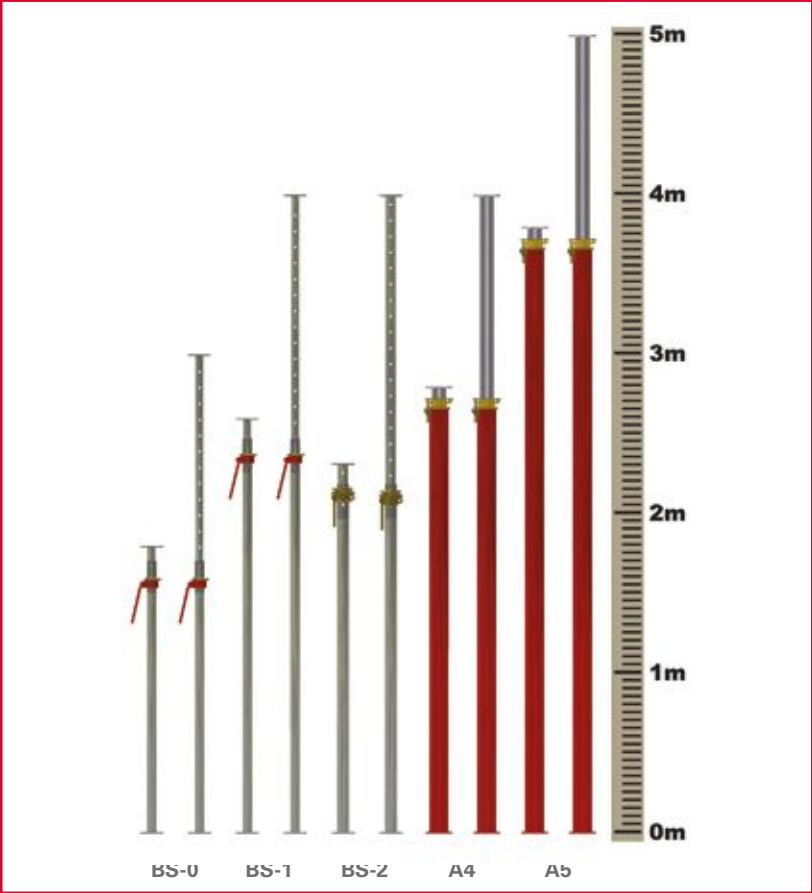

## Alu-Up Props

Alu-Up Props are used to support the Kwik-Deck system to a propping height of 5000mm (Single Prop).

CODE	DESCRIPTION	MASS(kg)
5105199	ALU-UP 4 PROP	25.0
5105200	ALU-UP 5 PROP	29.3

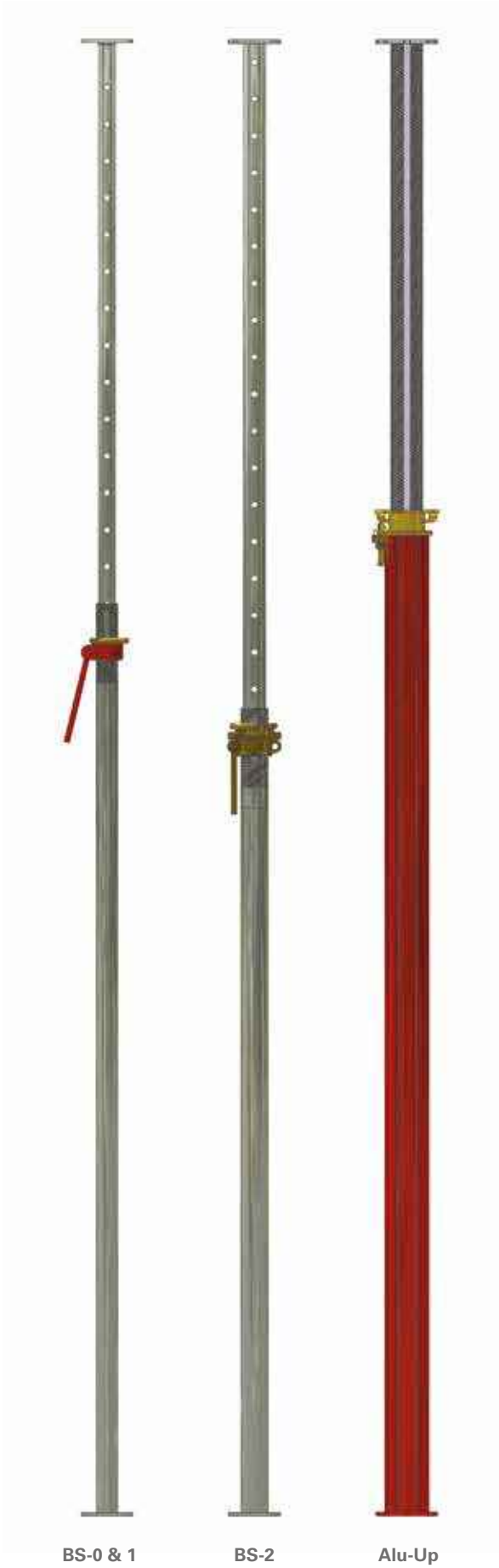

## Alu-Up Prop Stubs and Extensions

Alu-Up Prop Extensions are used to extend the propping height in small intervals. The Stubs are bolted to the bottom of all Props as a protection piece.

CODE	DESCRIPTION	MASS(kg)
5105205	ALU-UP EXTENSION 1000	12.2
5105204	ALU-UP EXTENSION 500	7.5
5105210	ALU-UP STUB 150	4.3



## Alu-Up Trusses

Alu-Up Trusses are used to create towers and brace the Alu-Up Props. It further enhances the stability and loading capacity of the Props.

CODE	DESCRIPTION	MASS(kg)
5105206	ALU-UP TRUSS 2500	32.3
5105207	ALU-UP TRUSS 1800	26.1
5105208	ALU-UP TRUSS 1600	24.4
5105209	ALU-UP TRUSS 1294	21.8
5105212	ALU-UP TRUSS 900	15.8

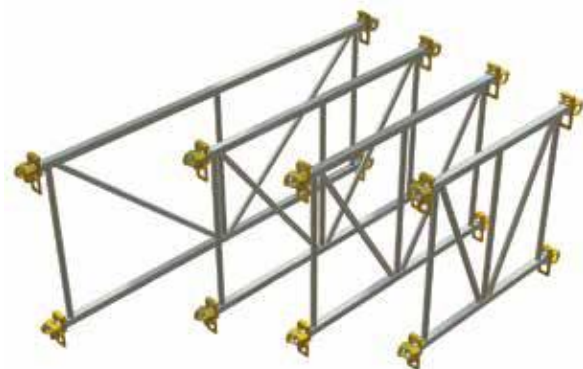

## BS Prop Tri-pods

BS Prop Tri-pods are used to keep the BS Props plumb during the erection phase.

CODE	DESCRIPTION	MASS(kg)
1130017	BS PROP TRI-POD	10.1



## Alu-Up Prop Tri-pods

Alu-Up Prop Tri-pods are used to keep the Alu-Up Props plumb during the erection phase.

CODE	DESCRIPTION	MASS(kg)
5105201	ALU-UP PROP TRI-POD	15.7



# Supportwork - Kwik-Stage

## Jacks and Base Plates

BT Jacks are inserted into the ends of Kwik-Stage Standards to provide the required vertical height adjustment and to secure the Kwik-Deck Drop-Heads in position.

Kwik-Stage Base Plates are inserted into the bottom end of Kwik-Stage Standards to spread the load onto the bearing surface.

CODE	DESCRIPTION	MASS(kg)
0135302	KWIK-STAGE BT BASE PLATE	1.6
0140335	KWIK-STAGE 610 R/O BT BASE JACK	4.2



## Kwik-Stage Standards

Kwik-Stage Standards make-up the vertical supports for formwork and access.

CODE	DESCRIPTION	MASS(kg)
1105005	KWIK-STAGE STANDARD 3000	15.5
1105004	KWIK-STAGE STANDARD 2500	12.9
1105003	KWIK-STAGE STANDARD 2000	10.3
1105002	KWIK-STAGE STANDARD 1500	7.7
1105001	KWIK-STAGE STANDARD 1000	5.2
1105000	KWIK-STAGE STANDARD 500	2.6
1105045	KWIK-STAGE STANDARD 250 C/W SOCKET	2.6



## Application - Kwik-Stage Supportwork

Two bays of Kwik-Stage are used around the perimeter of all Kwik-Deck slabs, irrespective of the supportwork system used. This provides stability to the entire structure and facilitates a safe, cantilevered working platform around the perimeter when using the Kwik-Deck Cantilever Bracket. Kwik-Stage further acts as a safe and secure handrail barrier around the deck. It is also used as the setting-out point for the entire deck - starting at the four corner columns working inwards and leaving only two main patch lines.



### Kwik-Stage Ledgers

Kwik-Stage Ledgers are horizontal members used to keep the Kwik-Stage Standards in the vertical position.

CODE	DESCRIPTION	MASS(kg)
1105021	KWIK-STAGE LEDGER 2500	9.0
1105022	KWIK-STAGE LEDGER 2000	7.3
1105018	KWIK-STAGE LEDGER 1800	6.6
1105034	KWIK-STAGE LEDGER 1600	5.7
1105024	KWIK-STAGE LEDGER 1294	5.0
1105027	KWIK-STAGE LEDGER 1000	3.4
1105049	KWIK-STAGE LEDGER 925	3.2
1105029	KWIK-STAGE LEDGER 900	3.1
1105037	KWIK-STAGE LEDGER 700	2.6
1105032	KWIK-STAGE LEDGER 600	2.4



### Scaffold Tubes and Swivel Couplers

Scaffold Tubes are used for a variety of applications in supportwork and access scaffolding, i.e. bracing, lacing, handrails etc. Swivel Couplers attach Scaffold Tubes to Standards and Jacks in any direction.

CODE	DESCRIPTION	MASS(kg)
1905151	SCAFFOLD TUBE 6100	22.7
1905098	SCAFFOLD TUBE 5500	20.5
1905097	SCAFFOLD TUBE 5000	18.6
1905096	SCAFFOLD TUBE 4500	16.7
1905095	SCAFFOLD TUBE 4000	14.9
1905094	SCAFFOLD TUBE 3500	13.0
1905093	SCAFFOLD TUBE 3000	11.2
1905092	SCAFFOLD TUBE 2500	9.3
1905091	SCAFFOLD TUBE 2000	7.4
1905090	SCAFFOLD TUBE 1500	5.6
1905089	SCAFFOLD TUBE 1000	3.7
1905088	SCAFFOLD TUBE 500	1.9
1905059	50 X 50 SWIVEL COUPLER	1.5
1905100	38 X 48 SWIVEL COUPLER	1.2

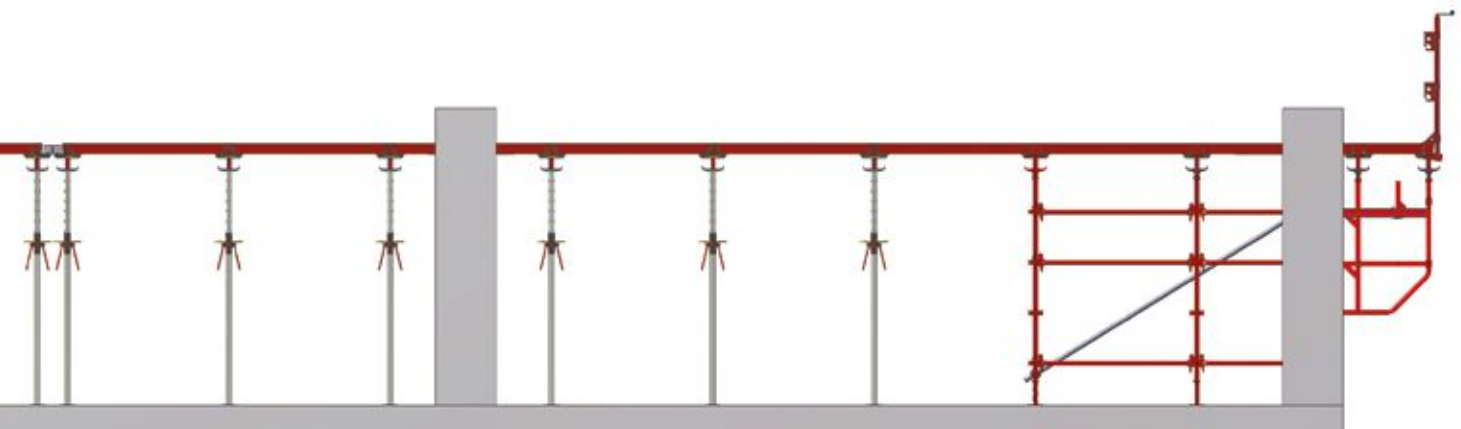

# Drop-Heads

## Kwik-Deck Drop-Head

The Kwik-Deck Drop-Head is used to support the Kwik-Deck Beam and Patch Plates, as well as to facilitate the Kwik-Strip action of the system.

CODE	DESCRIPTION	MASS(kg)
32001	KWIK-DECK DROP-HEAD	6.9



**Kwik-Deck Drop-Head on Alu-Up**



**Kwik-Deck Drop-Head on BS Prop**



**Kwik-Deck Drop-Head on Kwik-Stage**



## Kwik-Deck Drop-Head Unstripped Position

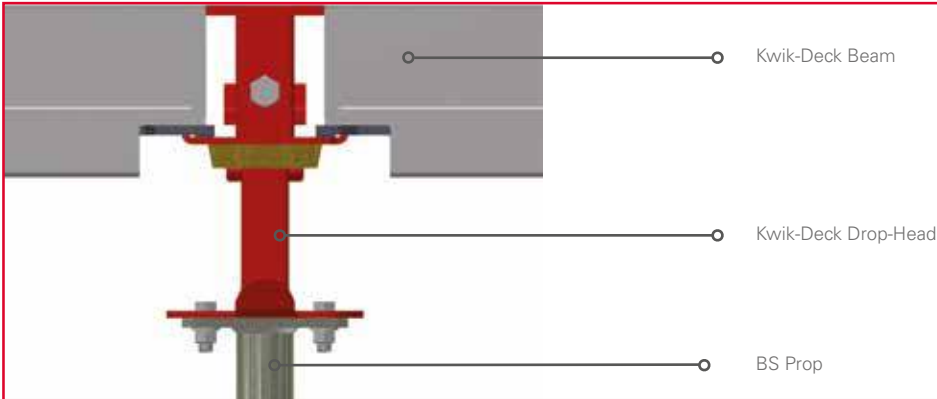

## Kwik-Deck Drop-Head Stripped Position

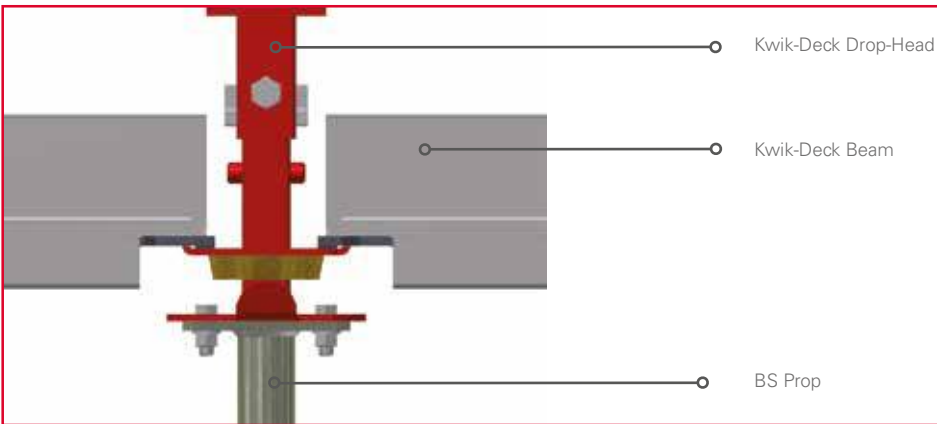

## Kwik-Deck Beams

Kwik-Deck Beams span between two Drop-Heads and support the Kwik-Deck Panels and Patch Beams. The Kwik-Deck Direction Change Beam allows the beam grid to change when the one end is hooked into the gutter of another beam.

CODE	DESCRIPTION	MASS(kg)
31004	KWIK-DECK BEAM 2500	31.7
31003	KWIK-DECK BEAM 1800	21.7
31006	KWIK-DECK BEAM 1500	18.1
31007	KWIK-DECK BEAM 1200	14.5
31002	KWIK-DECK BEAM 900	11.0
31001	KWIK-DECK BEAM 600	7.6
31005	KWIK-DECK DIRECTION CHANGE BEAM	7.4

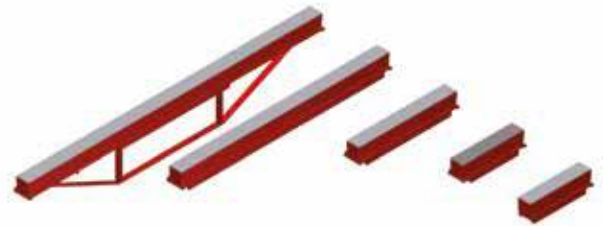

## Kwik-Deck Panels

Kwik-Deck Panels are used to form a flat deck, supported by two Kwik-Deck Beams.

CODE	DESCRIPTION	MASS(kg)
30001	KWIK-DECK PANEL 1500 X 600	19.4
30002	KWIK-DECK PANEL 1500 X 300	12.9
30003	KWIK-DECK PANEL 1500 X 150	9.3
30004	KWIK-DECK PANEL 1194 X 600	15.6
30005	KWIK-DECK PANEL 1194 X 300	10.3
30006	KWIK-DECK PANEL 1194 X 150	7.3
30007	KWIK-DECK PANEL 800 X 600	11.2
30008	KWIK-DECK PANEL 800 X 300	7.3
30009	KWIK-DECK PANEL 800 X 150	5.1
37001	KWIK-DECK CORNER PANEL	12.0



## Application - Direction Change Beam

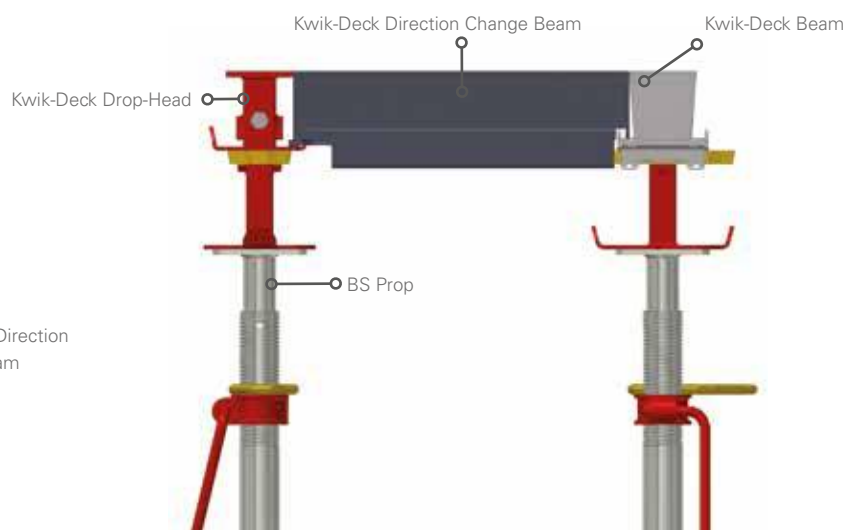
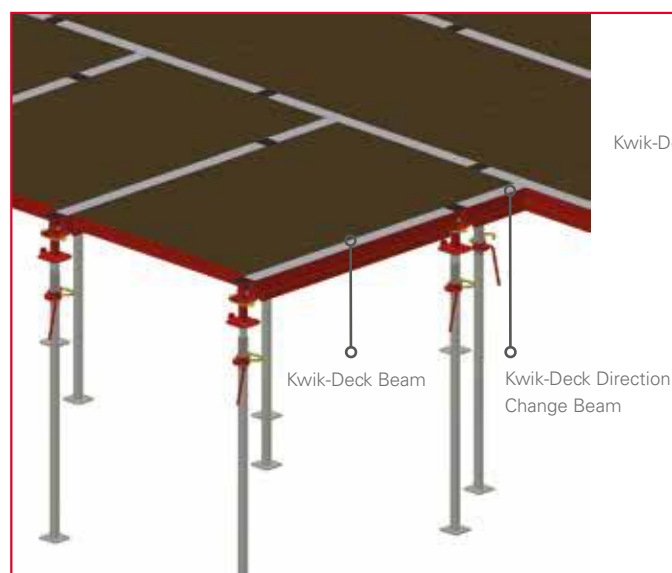

## Kwik-Deck Patch Beams

Kwik-Deck Patch Beams facilitate patching in all directions. The Patch Beams are supported on either the gutter of the Kwik-Deck Beam, the gutter of another Patch Beam or on the Kwik-Deck Patch Plate.

CODE	DESCRIPTION	MASS(kg)
33006	KWIK-DECK PATCH BEAM 2500	21.5
33005	KWIK-DECK PATCH BEAM 1800	15.6
33004	KWIK-DECK PATCH BEAM 1500	17.7
33003	KWIK-DECK PATCH BEAM 1194	14.2
33002	KWIK-DECK PATCH BEAM 800/900	9.6
33001	KWIK-DECK PATCH BEAM 600	6.9

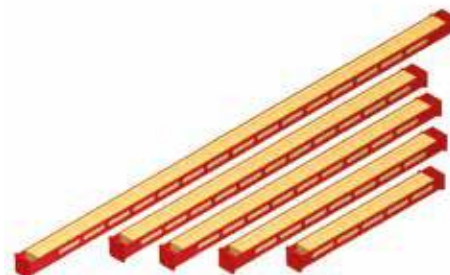

## Kwik-Deck Patch Plate

The Kwik-Deck Patch Plate slides onto the Kwik-Deck Drop-Head to support a Patch Beam in any one of four directions. This leaves 19mm from the top of the Patch Beam to the deck for placing of plywood.

CODE	DESCRIPTION	MASS(kg)
33007	KWIK-DECK PATCH PLATE	2.5



## General - Patching Solution Facilities Downstand Beams

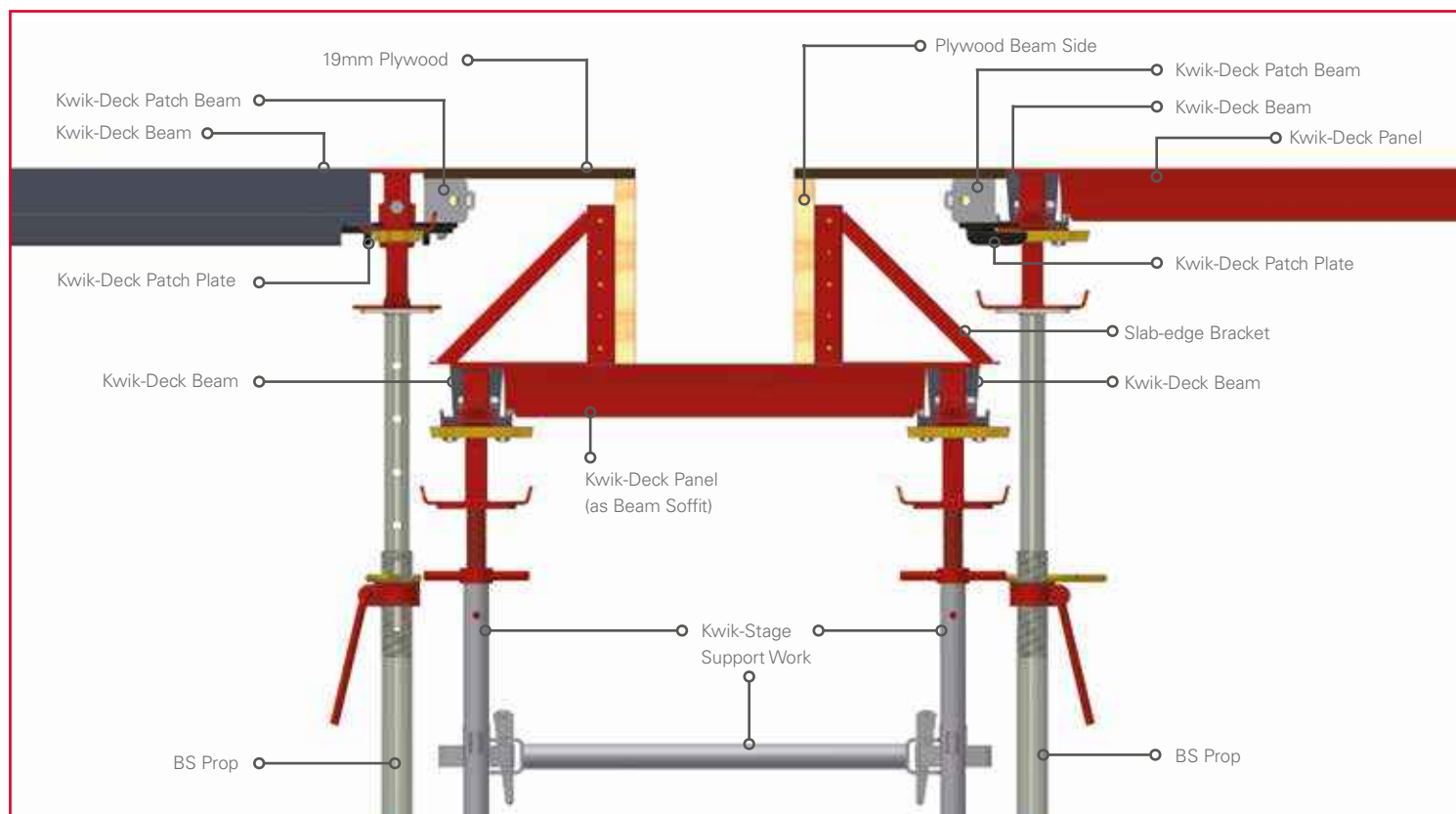



## Kwik-Deck Patching Alongside Panels

Patch Beams can run alongside the length of any Kwik-Deck Panel. Patch Beams are hooked onto Patch Plates to support plywood patching.

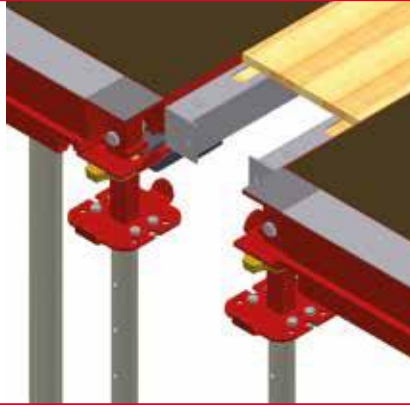

## Kwik-Deck Patching Alongside Beams

Patch Beams can run alongside the length of any Kwik-Deck Beam. Patch Beams are hooked onto Patch Plates to support plywood patching.

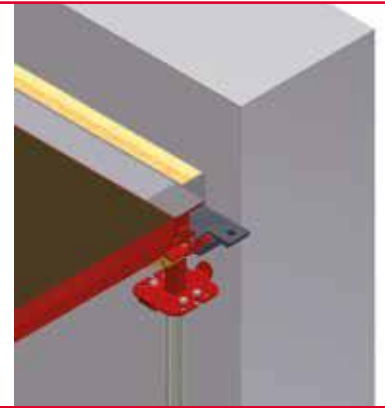
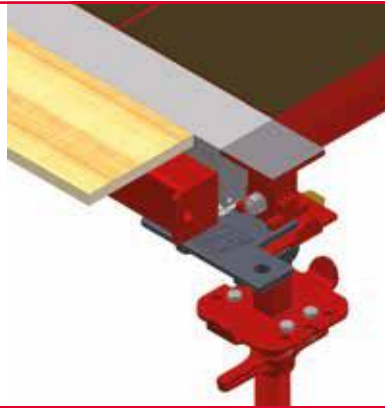

## Kwik-Deck Patching Alongside Columns

Patch Beams can hook into the gutter of any Kwik-Deck Beam or into the gutter of another Patch Beam when patching around columns.

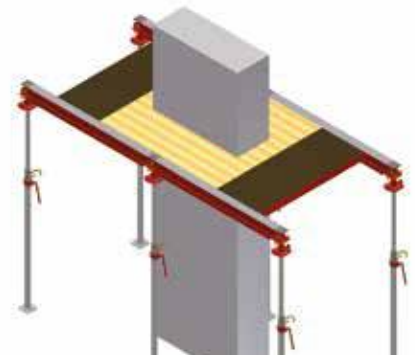
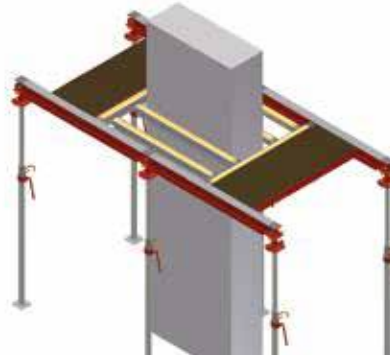

## Kwik-Deck Patching in Two Directions

Patching is simple, even when two patch lines meet.

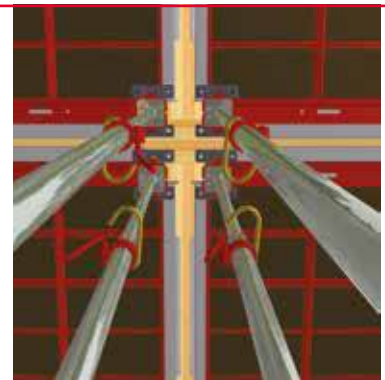
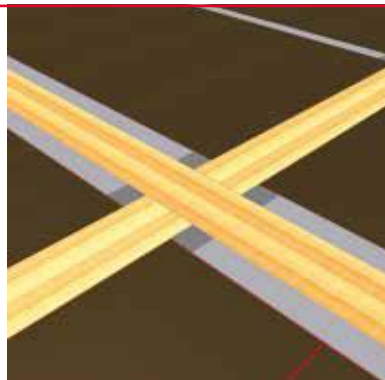

# Cantilevers

## Kwik-Deck Cantilever Bracket

The Kwik-Deck Cantilever Bracket simply hooks onto the Kwik-Stage Standard, creating a safe cantilevered working platform. Hook-on Boards can be placed onto the Cantilever Bracket to assist in the safe erection and dismantling of the Kwik-Deck system. Its unique multiple support points eliminate any direction change of the decking grid.

CODE	DESCRIPTION	MASS(kg)
39001	KWIK-DECK CANTILEVER BRACKET	25.7
1105076	HOOK-ON BOARD 2500	20.4
1105079	HOOK-ON BOARD 1800	15.5
1105075	HOOK-ON BOARD 1600	14.1
1105070	HOOK-ON BOARD 1294	11.6
1105065	HOOK-ON BOARD 900	8.9



## Kwik-Deck Outrigger

The Kwik-Deck Outrigger assembly creates an off-the-slab support point just outside the corner column. When used with the Kwik-Deck Cantilever Bracket, the ultimate corner solution is achieved – safe, stable and economical. It facilitates a safe, cantilevered working platform around the corner column on multi-story buildings without having to support it from ground level up. The Outrigger assembly is trapped between two poured slabs by placing Props onto the Kwik-Deck Outrigger Support Beams. Two cup-end tubes on the Outrigger Beam provide support for a Hook-on Board and a Kwik-Stage Cage to form a safe working platform, from where the off-the-slab supportwork can be recovered.

CODE	DESCRIPTION	MASS(kg)
36001	KWIK-DECK OUTRIGGER BEAM	72.0
36002	KWIK-DECK OUTRIGGER SUPPORT BEAM	38.2



## Application - Outrigger Beam

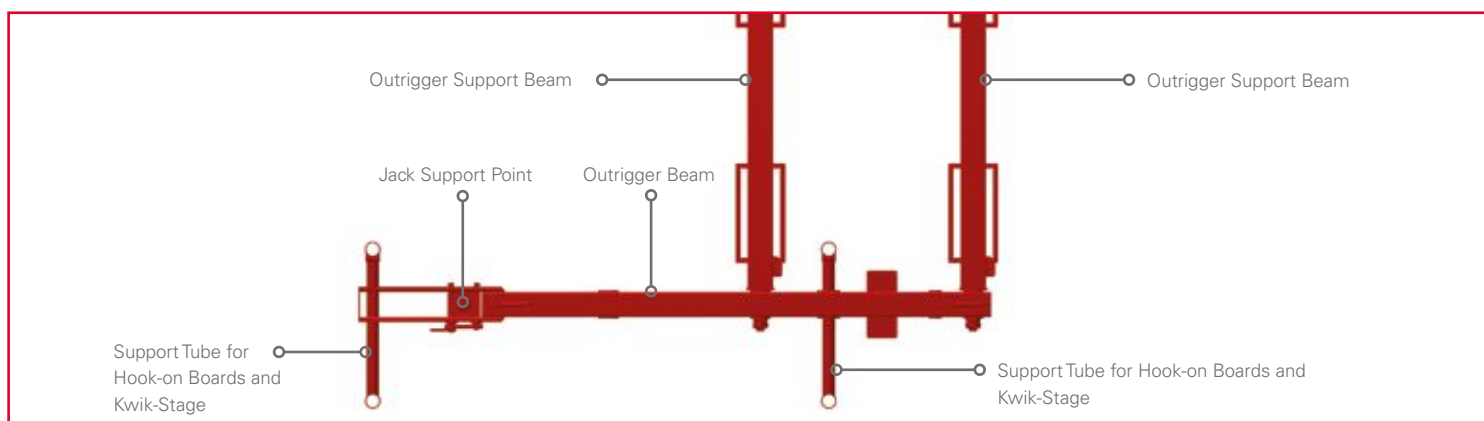



## Application - Typical Kwik-Stage Layout for Columns up to 600mm

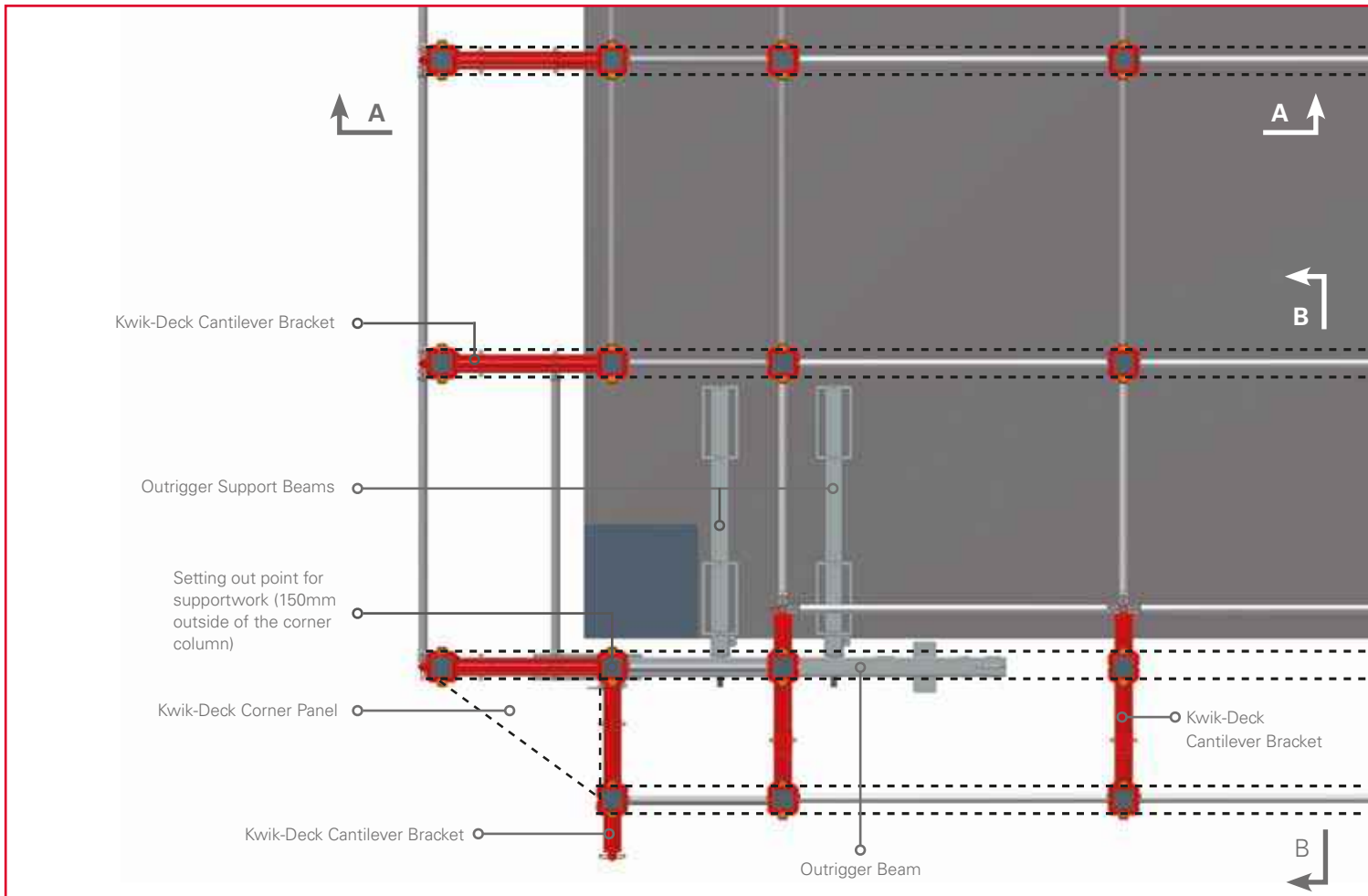

## Application - Kwik-Stage Perimeter with Cantilevers

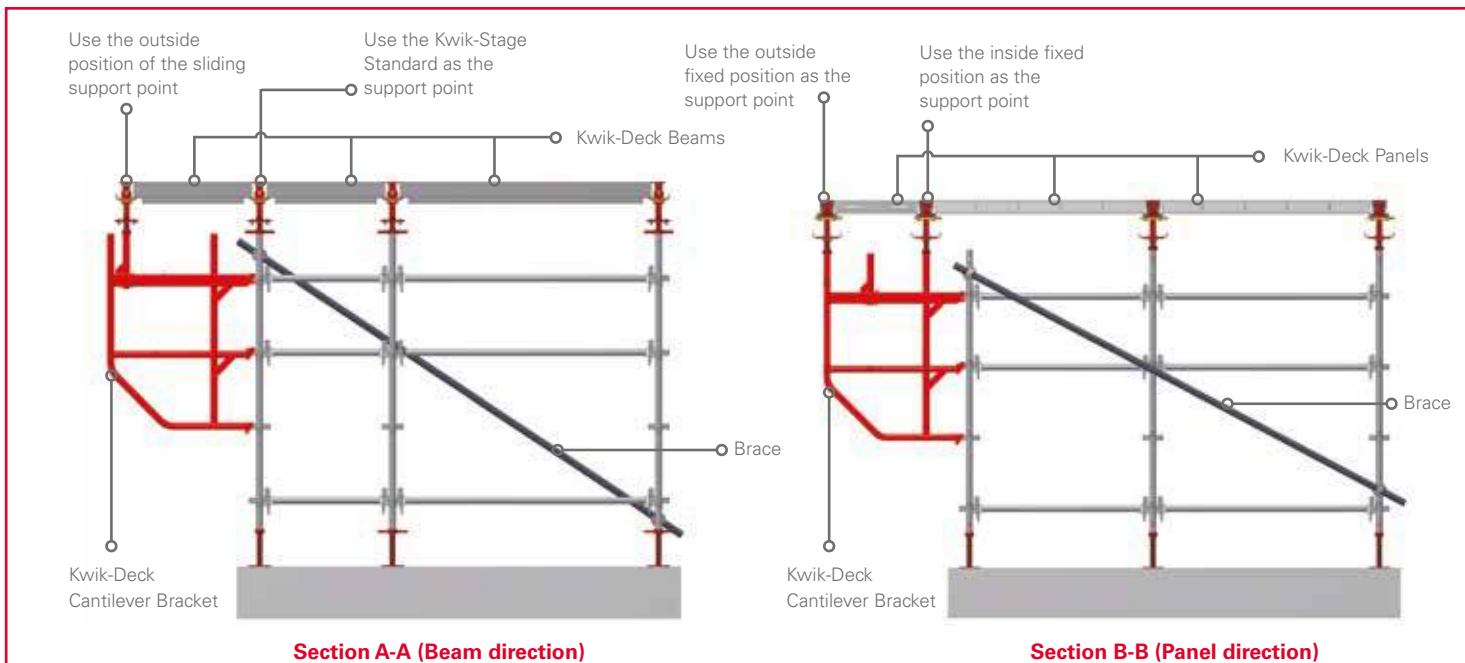

**Note:** 2 Bays of Kwik-Stage must be erected around the entire slab perimeter in the correct format. Overturning loads and concrete loads are safely transferred only if used in the prescribed format. Please contact your nearest Form-Scaff Design Office for a formwork layout.

## Application - Cantilever Bracket and Outrigger Beam

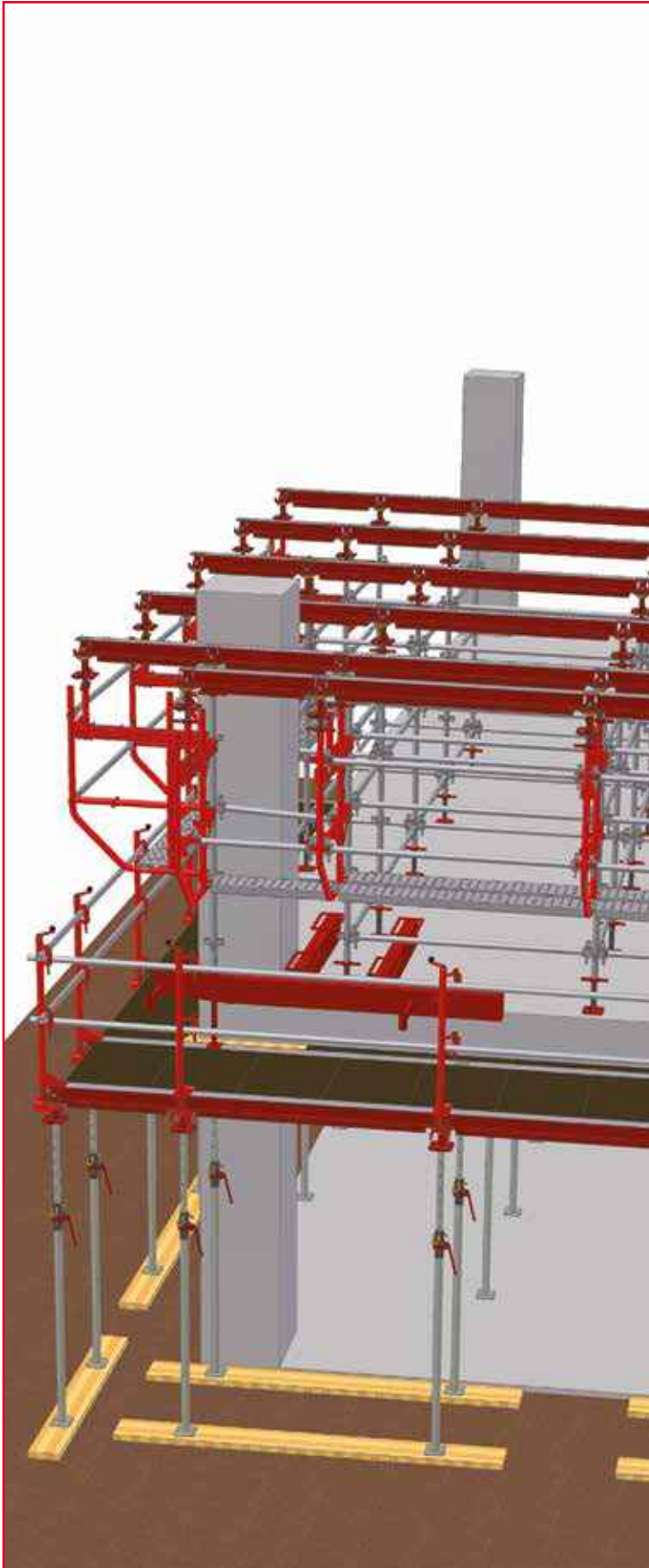

Typical Second Floor Stage

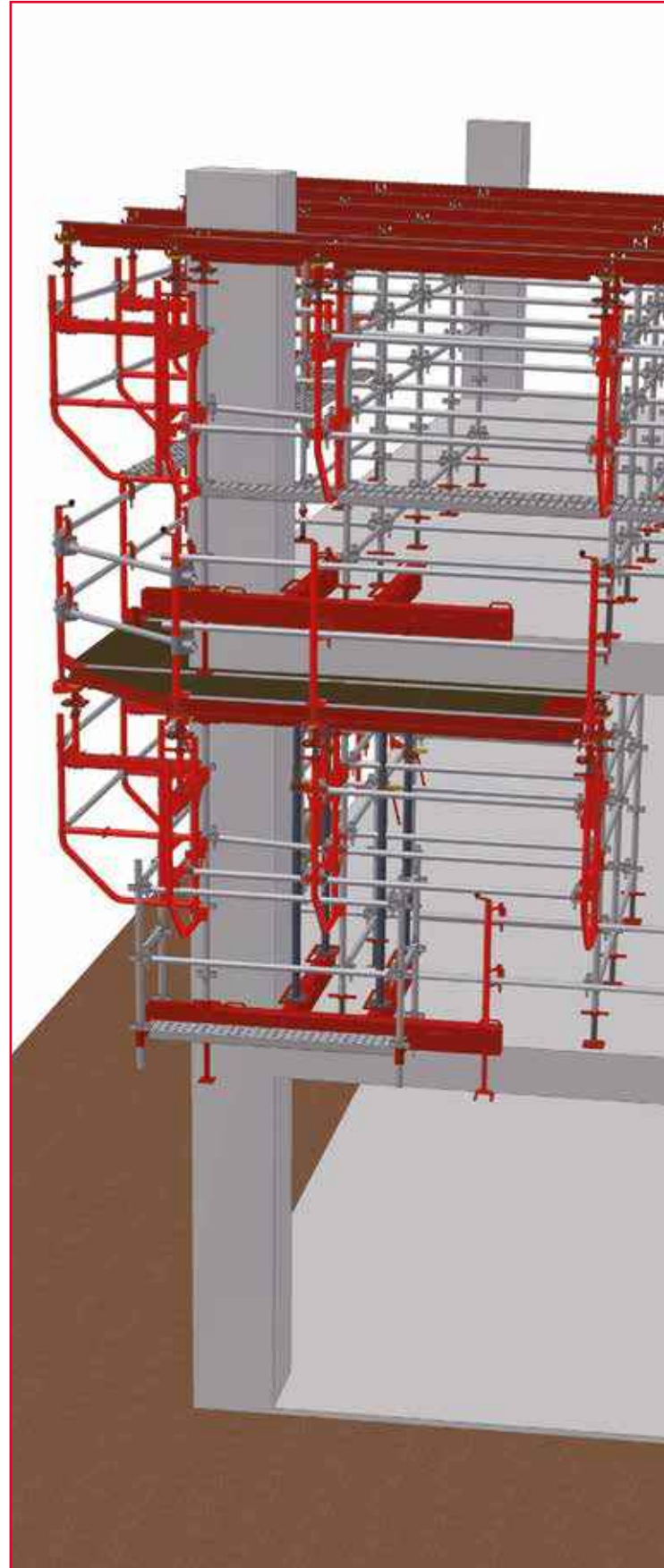

Typical Third Floor Stage

### Kwik-Deck Guardrail Bracket

The Kwik-Deck Guardrail Bracket is used to create a safe guardrail around the perimeter of the deck, by attaching it to the Kwik-Deck Drop-Head in any direction. Its unique design further allows it to be clamped on already cast slabs of up to 900mm deep as well as any other rectangular shaped objects.

CODE	DESCRIPTION	MASS(kg)
1130239	KWIK-DECK GUARDRAIL BRACKET	15.3



### Application - Kwik-Deck Guardrails



# Slab-Edges

## Slab-Edge Bracket

The 300mm high Slab-Edge Bracket facilitates the installation of slab stop-ends. Fastening the bracket to the Kwik-Deck Panel is done with either nails or screws. The slab-edge form (plywood) is fastened to the vertical timber insert.

CODE	DESCRIPTION	MASS(kg)
37003	SLAB-EDGE BRACKET	4.3

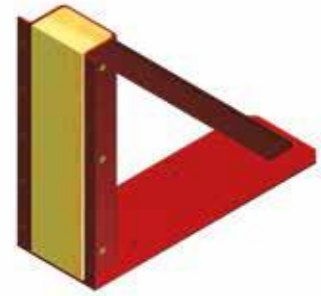

## Application - Slab-Edges

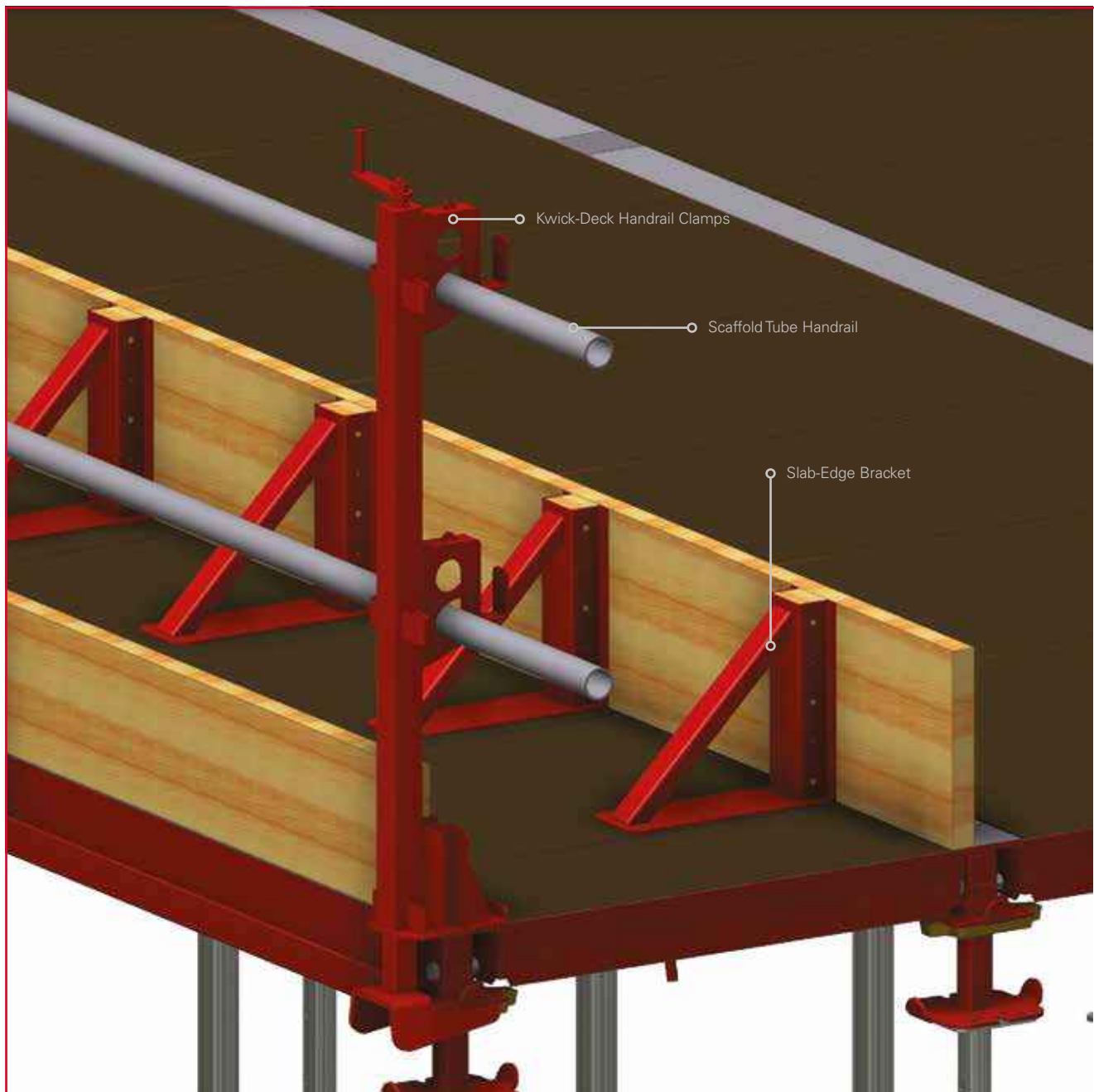

### International Branches

#### Botswana - Gaborone

Plot 31364, Gaborone North,  
Gaborone,  
Botswana  
+267 396 2000

#### Eswatini - Matsapha

36 Ingaja Street,  
Matsapha,  
Eswatini  
+268 2518 8360

#### Ghana - Accra

Plot 29, Off Spintex Road, Tema  
Motorway Industrial Area, Accra,  
Ghana  
+233 303 973 722

#### Mauritius - Port Louis

72201, Petit Camp,  
Phoenix (Near Bagatelle Dam),  
Mauritius  
+230 286 6176 / +230 5940 2551

#### Mozambique - Maputo

Belulane, Parcella 15988, Boane  
Matola Rio, Maputo,  
Mozambique  
+258 84 163 8905

#### Namibia - Windhoek

Cnr Nickle & Michelle, McClean Street,  
Prosperita, Windhoek,  
Namibia  
+264 61 425 350

#### Tanzania – Dar es Salaam

Cnr Mwaikibaki Road & Kilimani Close  
Plot 1034/5 Mbezi Kawe  
Dar es Salaam, Tanzania  
+255 74 299 8022

#### Zambia - Kitwe

12867 Chingola Road, Saloba Business Park,  
Chimwemwe, Kitwe,  
Zambia  
+260 966 880 009

#### Zambia - Lusaka

Plot 397 A/3/B Kafue Road  
Lusaka,  
Zambia  
+260 968 491 061

#### Zambia - Solwezi

Suite 12, Kansanshi Road, Plot No 2945,  
Solwezi,  
Zambia  
+260 768 935 762

### South African Branches

#### Ballito

Labora Terra Industrial Park  
Shakas Rock Road, Umhlali  
Ballito, KwaZulu Natal  
+27 (0) 32 947 9430

#### Bloemfontein

26 Tibbie Visser Street  
Estoire, Bloemfontein  
Free State  
+27 (0) 51 432 5555

#### Cape Town

6 Rondevallei Road, Hagley  
Kuilsrivier, Cape Town  
Western Cape  
+27 (0) 21 528 6500

#### Durban

16 Stroude Place, Prospection  
Isipingo,  
KwaZulu Natal  
+27 (0) 31 902 2677

#### East London

5 Ray Craib Crescent,  
Beacon Bay North  
Beacon Bay, Eastern Cape  
+27 (0) 43 748 2558

#### Emalahleni

Stand 64, Geodesic Crescent  
Marelden Ext 3  
Mpumalange  
+27 (0) 13 690 2833

#### George

10 Ring Road, George Industrial  
George,  
Western Cape  
+27 (0) 44 695 0204

#### Gqeberha

4 Kendle Street  
Neave Industrial Area,  
Eastern Cape  
+27 (0) 41 453 2317

#### Kathu

33 Kalk Street, Industrial Area  
Kathu,  
Northern Cape  
+27 (0) 53 723 2194

#### Margate

Airport Park, Links Road  
Margate Ext 3,  
KwaZulu Natal  
+27 (0) 39 317 1708

#### Mbombela

Erf 379, Rocky Drift  
White River,  
Mbombela  
+27 (0) 13 758 1036

#### Midrand

Poplar Crescent, Lords View  
Industrial Park, Klipfontein  
Chloorkop X66, Gauteng  
+27 (0) 10 601 6313

#### Newcastle

6 Schonland Street  
Riverside Industrial Area  
Newcastle, KwaZulu Natal  
+27 (0) 34 375 7697

#### Polokwane

62 Goud Street, Laboria  
Polokwane Ext 8,  
Limpopo  
+27 (0) 15 293 0450

#### Richards Bay

111 Allumina Allee St,  
Alton, Richards Bay  
KwaZulu Natal  
+27 (0) 35 751 1140

#### Rustenburg

3 Ferro Street, Rustenburg  
North West Province  
+27 (0) 14 538 2540

### Head Office

181 Barbara Road,  
Elandsfontein, Gauteng  
Tel +27 (0) 11 842 4000



Waco Africa / Head Office:  
181 Barbara Road, Elandsfontein, Gauteng  
Tel: +27 (0) 11 842 4000



[www.formscaff.com](http://www.formscaff.com)

