

Product Catalogue
Support Work

FS kwik-stage



FS form-scaff

Formwork & Scaffolding
Solutions

We are
WACO



Form-Scaff is South Africa's leading supplier of formwork, falsework and scaffolding to the construction and civil engineering industries. Form-Scaff not only manufactures, hires and sells world-class products, but also provides the design skills, technical advice and support that comes with having 50 years experience and more than 30 branches locally and internationally.

We are Waco International

Form-Scaff is part of Waco International, a focused equipment rental and industrial services business with operations in Africa (South Africa and other sub-Saharan African countries), Australasia (Australia and New Zealand) and the United Kingdom.

The Group provides services in the areas of formwork, shoring and scaffolding, insulation, painting and blasting, hydraulics and suspended access platforms, relocatable modular buildings, portable sanitation products and integrated hygiene services.

Disclaimer:

Copyright in this catalogue vests in Form-Scaff, a division of Waco Africa (Proprietary) Limited ("Form-Scaff") and extends inter alia, to the making of copies in whole or in part without the prior written consent of Form-Scaff.

While every effort has been made to ensure the accuracy of the information in this catalogue, we cannot accept responsibility for any errors which may occur as a result of reliance on the contents of this catalogue and are not liable for any loss of any nature that may be incurred as a result of such reliance. Details of any of the products may change without prior notice.

The customer must ensure that 'good practice' is adopted on site by competent persons and that the products shown in this catalogue are erected, used and stripped in accordance with the relevant Codes of Practice and the OHS Act and Regulations 95 of 1993. This catalogue does not contain any design detail but lists and depicts the items available under this product range. The responsibility for design is the responsibility of the customer.

Note: The colours used in this document are for illustrative purposes only and may differ on actual products

Contents



kwik-stage

Page 2 Kwik-Stage Overview

Page 3 General Assembly

Page 4 Standards & Ledgers

Page 6 Top Jacks

Page 9 Fittings

Page 10 Bracing

Page 11 Beam Bearers

Contact Details

Page 13 Head Office & Branches

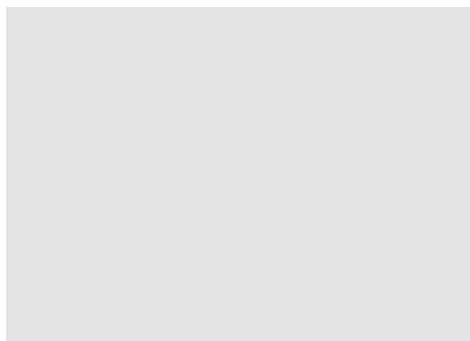
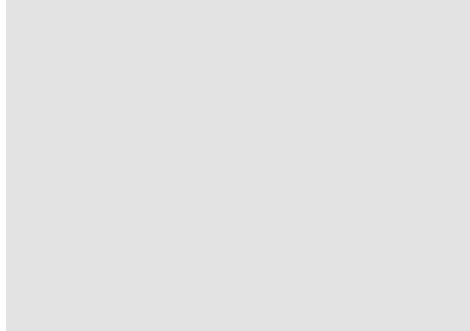



kwik-stage



Kwik-Stage Supportwork

Form-Scaff's Kwik-Stage system has been in use from the mid 1970's and almost 40 years later is still the system of choice for supporting concrete soffits.

Versatile, robust and cost effective, Kwik-Stage has proven its ability to cope with local conditions.

System Features

- 42kN system.
- Modular design ensures ease of use.
- Versatile height and width configurations.
- Safe working platforms.
- Compatible with the Super-Scaff system.
- Conforms to all South African standards and regulations.



General Assembly

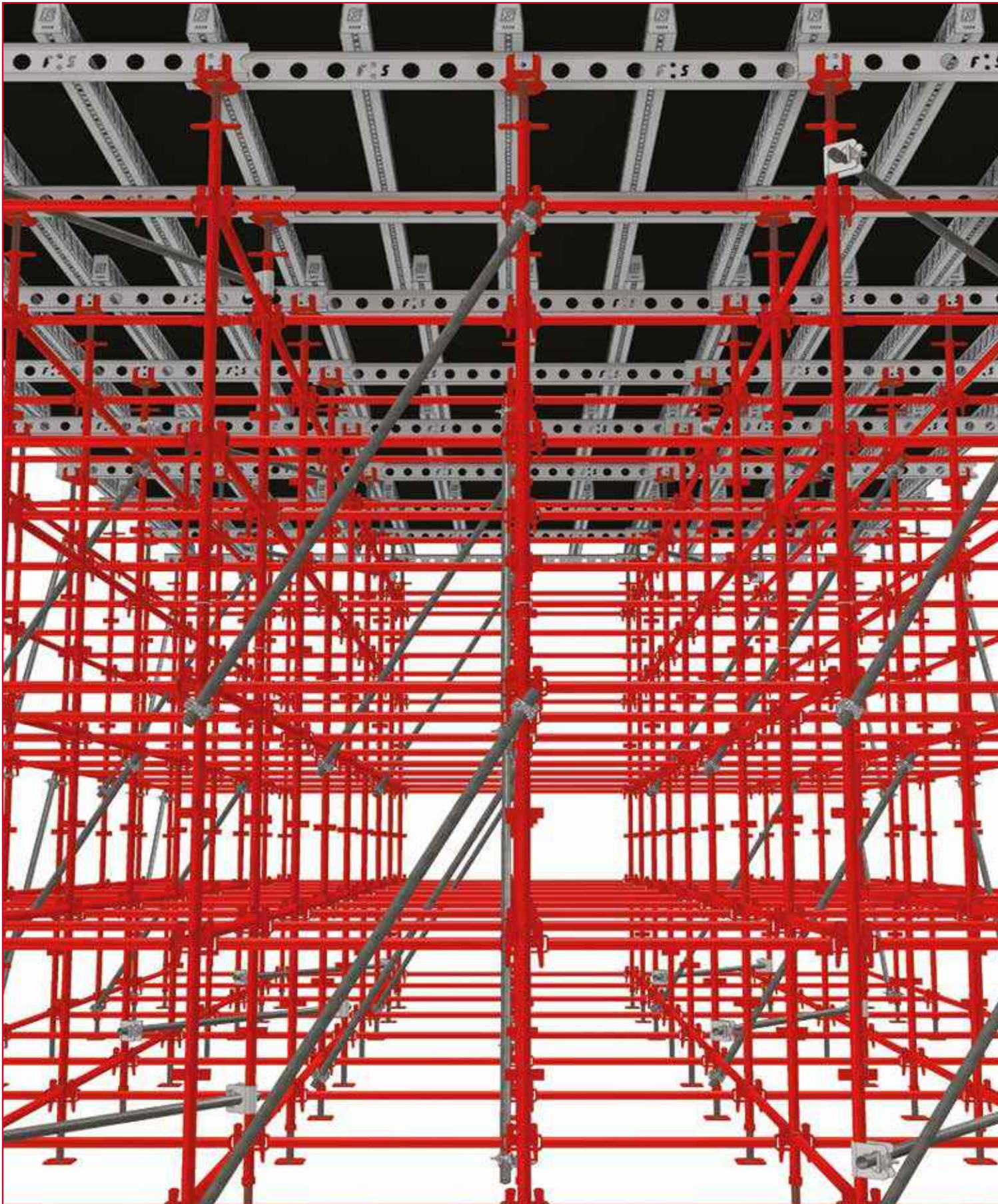

Standards & Ledgers

Jacks and Base Plates

Kwik-Stage Base Jacks are inserted into the ends of Kwik-Stage Standards to provide the required vertical height adjustment.

Kwik-Stage Base Plates are inserted into the bottom end of Kwik-Stage Standards to spread the load onto the bearing surface.

CODE	DESCRIPTION	MASS(kg)
0135302	KWIK-STAGE BT BASE PLATE	1.6
0140335	KWIK-STAGE 610 R/O BT BASE JACK	4.2



Kwik-Stage Standards

Kwik-Stage Standards make-up the vertical supports for bearers, formwork and access.

CODE	DESCRIPTION	MASS(kg)
1105005	KWIK-STAGE STANDARD 3000	15.5
1105004	KWIK-STAGE STANDARD 2500	12.9
1105003	KWIK-STAGE STANDARD 2000	10.3
1105002	KWIK-STAGE STANDARD 1500	7.7
1105001	KWIK-STAGE STANDARD 1000	5.2
1105000	KWIK-STAGE STANDARD 500	2.6
1105045	KWIK-STAGE STANDARD 250 C/W SOCKET	2.6



Connectors

Kwik-Stage Connectors are used to locate Standards on top of each other.

CODE	DESCRIPTION	MASS(kg)
0145341	KWIK-STAGE CONNECTOR	0.4



Kwik-Stage Ledgers

Kwik-Stage Ledgers are horizontal members used to keep the Kwik-Stage Standards in a vertical position.

CODE	DESCRIPTION	MASS(kg)
1105021	KWIK-STAGE LEDGER 2500	9.0
1105022	KWIK-STAGE LEDGER 2000	7.3
1105018	KWIK-STAGE LEDGER 1800	6.6
1105034	KWIK-STAGE LEDGER 1600	6.0
1105023	KWIK-STAGE LEDGER 1500	5.7
1105024	KWIK-STAGE LEDGER 1294	5.0
1105025	KWIK-STAGE LEDGER 1219	4.7
1105026	KWIK-STAGE LEDGER 1200	4.7
1105027	KWIK-STAGE LEDGER 1000	3.4
1105029	KWIK-STAGE LEDGER 900	3.1
1105031	KWIK-STAGE LEDGER 800	2.9
1105037	KWIK-STAGE LEDGER 700	2.6
1105032	KWIK-STAGE LEDGER 600	2.4





Bridging Ledgers

Kwik-Stage Bridging Ledgers are used to bridge between two Standards, reducing the number of Standards required.

CODE	DESCRIPTION	MASS(kg)
1105106	KWIK-STAGE BRIDGING LEDGER 1800	21.3



Application - Bridging Ledgers

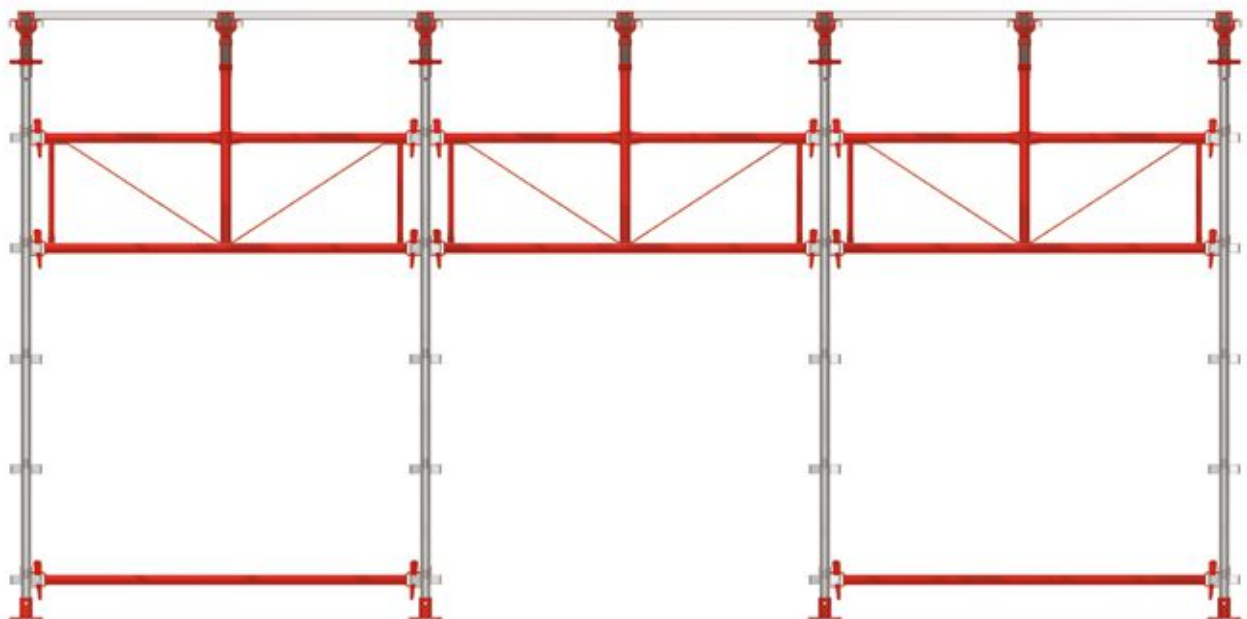

Top Jacks

U-Heads

U-Heads support bearers on top of Kwik-Stage including timber and steel bearers.

CODE	DESCRIPTION	MASS(kg)
0140326	KWIK-STAGE 610 TUBE R/O JACK	7.2
0140322	KWIK-STAGE 457 TUBE R/O JACK	6.5
0135306	KWIK-STAGE U-HEAD SPIGOT	4.0



J-Heads

J-Heads support bearers on top of Kwik-Stage including timber and steel bearers.

CODE	DESCRIPTION	MASS(kg)
0140325	KWIK-STAGE 610 R/O J.H JACK	4.7
0140321	KWIK-STAGE 457 R/O J.H JACK	4.0
0135303	KWIK-STAGE J-HEAD SPIGOT	1.5

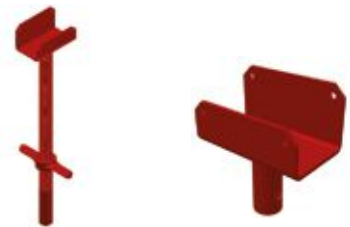

Fork Heads

Multi-Form Fork Heads can be used at the top of the Kwik-Stage BT Base Jack or Swivel Jack. Main Bearers centrally positioned over the Jacks.

CODE	DESCRIPTION	MASS(kg)
1130016	MULTI-FORM FORK-HEAD	1.8

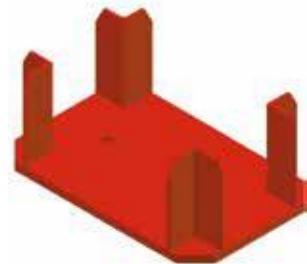

Swivel Jacks

Kwik-Stage Swivel Jacks are inserted into the ends of Kwik-Stage Standards when used on sloping surfaces to provide the required vertical height adjustment.

CODE	DESCRIPTION	MASS(kg)
0140350	KWIK-STAGE SWIVEL BASE JACK (SOLID)	10.7





Application - U-Heads



Application - J-Heads



Application - Fork Heads



Application - Swivel Jack

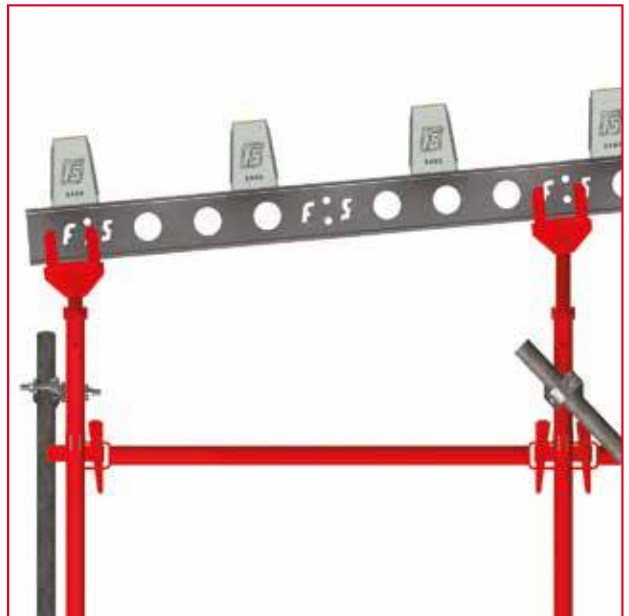

Application - Sloping Surfaces

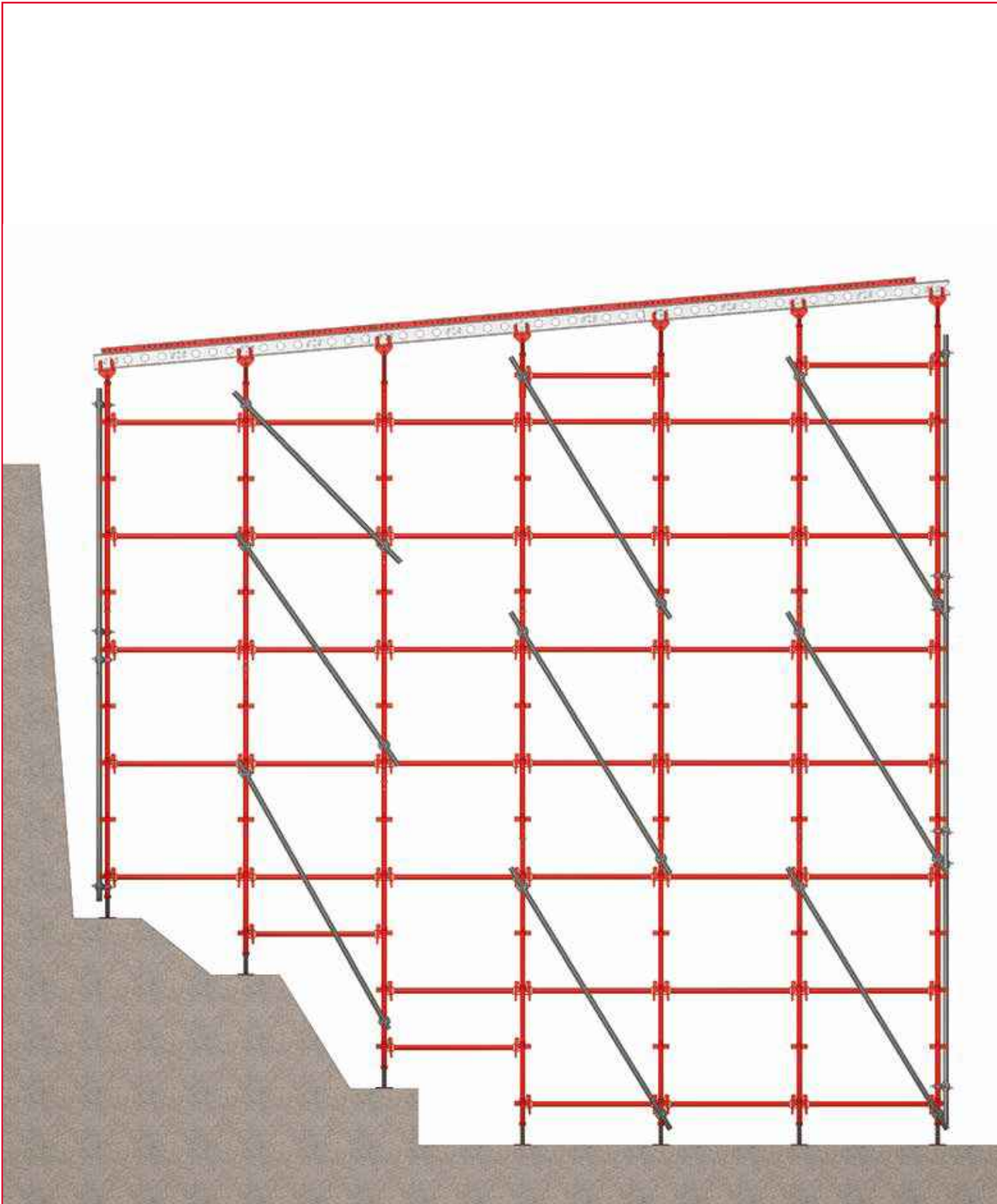

90° Couplers

90° Couplers are used to attach a Scaffold Tube to a Standard at 90°.

CODE	DESCRIPTION	MASS(kg)
1905016	50 X 50 COUPLER 90 DEGREE	1.5



Flange Couplers

Flange Couplers attach a Scaffold Tube to the flange of a channel iron or I beam.

CODE	DESCRIPTION	MASS(kg)
1905067	COUPLER (FLANGE TYPE)	1.1



DH Couplers

DH Couplers are used to connect a Scaffold Tube to a Standard at 90°.

CODE	DESCRIPTION	MASS(kg)
1905015	COUPLER DH	1.4



Internal Spigot Couplers

Internal Spigot Couplers are used to join two Scaffold Tubes end to end.

CODE	DESCRIPTION	MASS(kg)
1905019	INTERNAL SPIGOT COUPLER 50	1.1



Diagonal Braces

Kwik-Stage Diagonal Braces are used to brace Kwik-Stage.

CODE	DESCRIPTION	MASS(kg)
1105063	DIAG BRACE 3535 C/C 2500 X 2500	12.6
1105060	DIAG BRACE 3202 C/C 2500 X 2000	11.6
1105062	DIAG BRACE 2828 C/C 2000 X 2000	10.4
1105059	DIAG BRACE 2342 C/C 2000 X 1219	8.9
1105061	DIAG BRACE 2121 C/C 1500 X 1500	8.2



Scaffold Tubes

Scaffold Tubes are used for a variety of applications in support work and access scaffolding, i.e. bracing, lacing, handrails etc.

CODE	DESCRIPTION	MASS(kg)
1905151	SCAFFOLD TUBE 6100	22.7
1905098	SCAFFOLD TUBE 5500	20.5
1905097	SCAFFOLD TUBE 5000	18.6
1905096	SCAFFOLD TUBE 4500	16.7
1905095	SCAFFOLD TUBE 4000	14.9
1905094	SCAFFOLD TUBE 3500	13.0
1905093	SCAFFOLD TUBE 3000	11.2
1905092	SCAFFOLD TUBE 2500	9.3
1905091	SCAFFOLD TUBE 2000	7.4
1905090	SCAFFOLD TUBE 1500	5.6
1905089	SCAFFOLD TUBE 1000	3.7
1905088	SCAFFOLD TUBE 500	1.9



Swivel Couplers

50 x 50 Swivel Couplers attach Scaffold Tubes to Standards in any direction. 38 x 48 Swivel Couplers attach Scaffold Tubes to Base Jacks.

CODE	DESCRIPTION	MASS(kg)
1905059	50 X 50 SWIVEL COUPLER	1.5
1950100	38 X 48 SWIVEL COUPLER	1.1



Band and Plates

Band and Plates are used to attach Scaffold Tubes to Standards at 90°.

CODE	DESCRIPTION	MASS(kg)
1805054	BAND BACK PLATE & EYEBOLT	0.7
1905008	50 X 50 BAND	1.6



Base Pedestals

Kwik-Stage Base Pedestals are used for slab edge and ring beam support by cantilevering 150mm past the lower level slab.

CODE	DESCRIPTION	MASS(kg)
1105092	900 BASE PEDESTAL	16.1
1105095	1800 BASE PEDESTAL	52.1



Beam Bearers

Kwik-Stage Beam Bearers are supported on two Kwik-Strip Beams. The Beam Bearer supports an Econo-Form Panel as a Beam soffit. The Beam Stay plumbs the Beam Side Panel.

CODE	DESCRIPTION	MASS(kg)
1105091	BEAM BEARER	16.0
1105093	BEAM STAY	6.0



Application - Beams Bearers

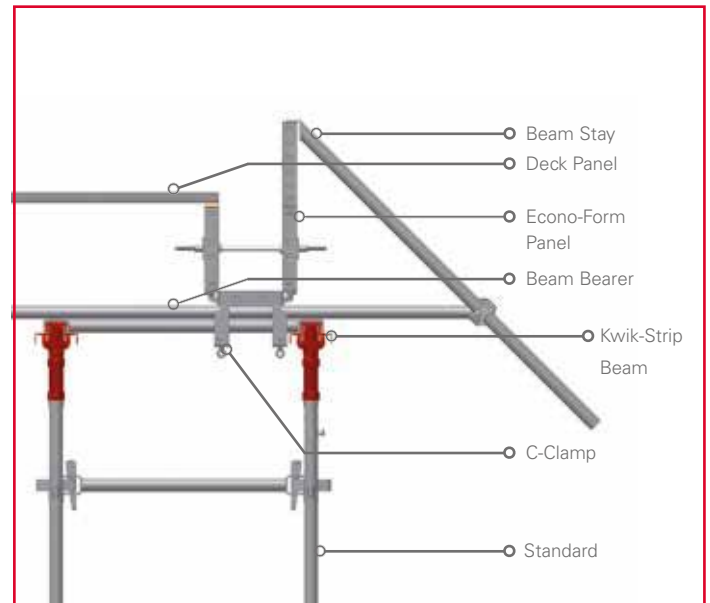
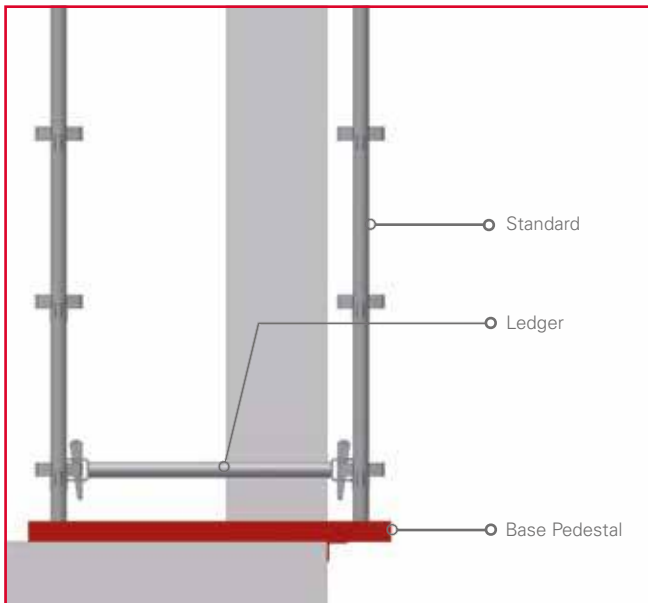

Application - Beam Bearers

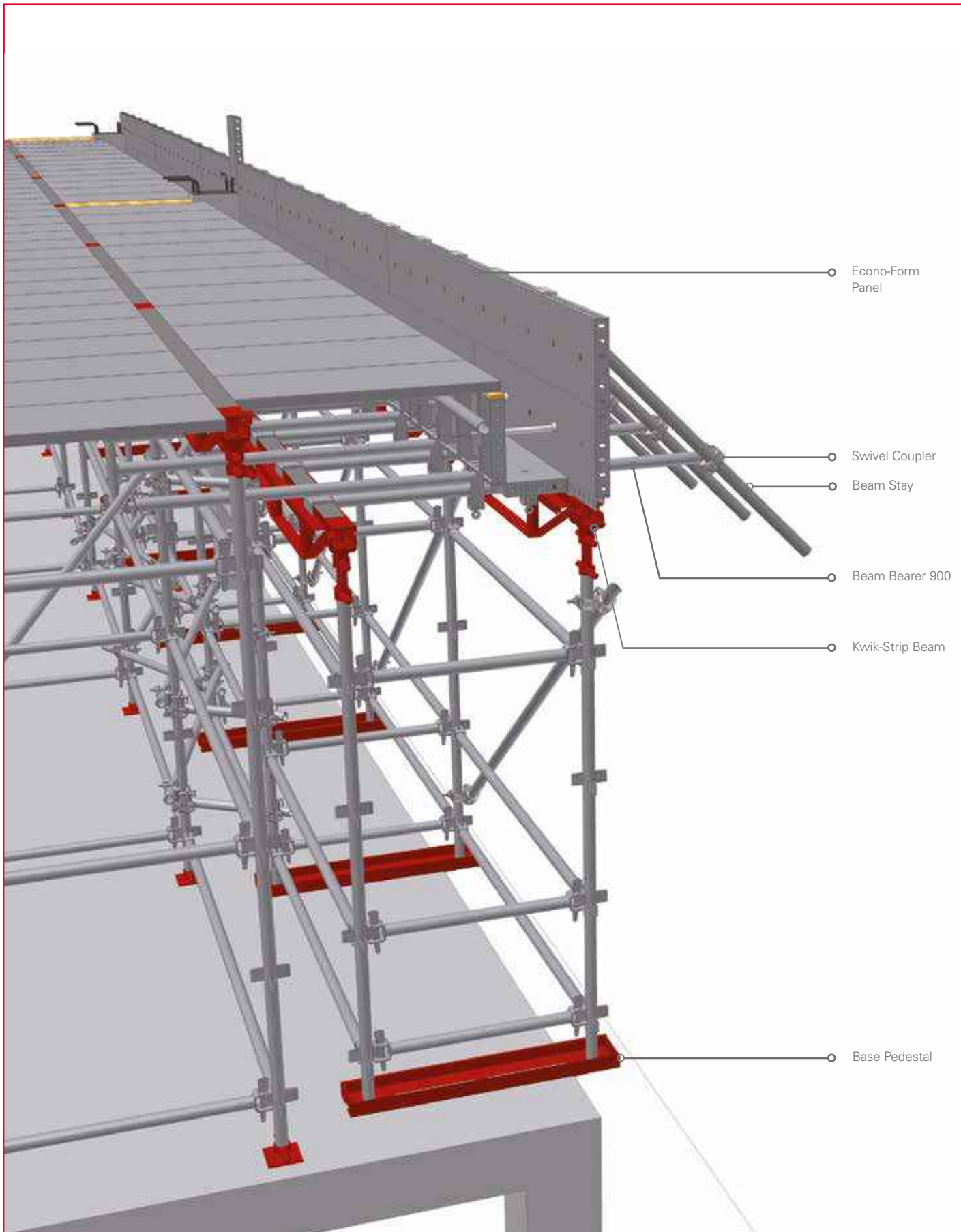

International Branches

Botswana - Gaborone

Plot 31364, Gaborone North,
Gaborone,
Botswana
+267 396 2000

Eswatini - Matsapha

36 Ingaja Street,
Matsapha,
Eswatini
+268 2518 8360

Ghana - Accra

Plot 29, Off Spintex Road, Tema
Motorway Industrial Area, Accra,
Ghana
+233 303 973 722

Mauritius - Port Louis

72201, Petit Camp,
Phoenix (Near Bagatelle Dam),
Mauritius
+230 286 6176 / +230 5940 2551

Mozambique - Maputo

Belulane, Parcella 15988, Boane
Matola Rio, Maputo,
Mozambique
+258 84 163 8905

Namibia - Windhoek

Cnr Nickle & Michelle, McClean Street,
Prosperita, Windhoek,
Namibia
+264 61 425 350

Tanzania – Dar es Salaam

Cnr Mwaikibaki Road & Kilimani Close
Plot 1034/5 Mbezi Kawe
Dar es Salaam, Tanzania
+255 74 299 8022

Zambia - Kitwe

12867 Chingola Road, Saloba Business Park,
Chimwemwe, Kitwe,
Zambia
+260 966 880 009

Zambia - Lusaka

Plot 397 A/3/B Kafue Road
Lusaka,
Zambia
+260 968 491 061

Zambia - Solwezi

Suite 12, Kansanshi Road, Plot No 2945,
Solwezi,
Zambia
+260 768 935 762

South African Branches

Ballito

Labora Terra Industrial Park
Shakas Rock Road, Umhlali
Ballito, KwaZulu Natal
+27 (0) 32 947 9430

Bloemfontein

26 Tibbie Visser Street
Estoire, Bloemfontein
Free State
+27 (0) 51 432 5555

Cape Town

6 Rondevallei Road, Hagley
Kuilsrivier, Cape Town
Western Cape
+27 (0) 21 528 6500

Durban

16 Stroude Place, Prospection
Isipingo,
KwaZulu Natal
+27 (0) 31 902 2677

East London

5 Ray Craib Crescent,
Beacon Bay North
Beacon Bay, Eastern Cape
+27 (0) 43 748 2558

Emalahleni

Stand 64, Geodesic Crescent
Marelden Ext 3
Mpumalange
+27 (0) 13 690 2833

George

10 Ring Road, George Industrial
George,
Western Cape
+27 (0) 44 695 0204

Gqeberha

4 Kendle Street
Neave Industrial Area,
Eastern Cape
+27 (0) 41 453 2317

Kathu

33 Kalk Street, Industrial Area
Kathu,
Northern Cape
+27 (0) 53 723 2194

Margate

Airport Park, Links Road
Margate Ext 3,
KwaZulu Natal
+27 (0) 39 317 1708

Mbombela

Erf 379, Rocky Drift
White River,
Mbombela
+27 (0) 13 758 1036

Midrand

Poplar Crescent, Lords View
Industrial Park, Klipfontein
Chloorkop X66, Gauteng
+27 (0) 10 601 6313

Newcastle

6 Schonland Street
Riverside Industrial Area
Newcastle, KwaZulu Natal
+27 (0) 34 375 7697

Polokwane

62 Goud Street, Laboria
Polokwane Ext 8,
Limpopo
+27 (0) 15 293 0450

Richards Bay

111 Allumina Allee St,
Alton, Richards Bay
KwaZulu Natal
+27 (0) 35 751 1140

Rustenburg

3 Ferro Street, Rustenburg
North West Province
+27 (0) 14 538 2540

Head Office

181 Barbara Road,
Elandsfontein, Gauteng
Tel +27 (0) 11 842 4000



Waco Africa / Head Office:
181 Barbara Road, Elandsfontein, Gauteng
Tel: +27 (0) 11 842 4000



www.formscaff.com

